



## BURLEIGH COUNTY WATER RESOURCE DISTRICT AGENDA

Tuesday, December 9, 2025 at 8:00 am

**Tom Baker Room, 221 N. 5<sup>th</sup> Street Bismarck**

8:00 a.m. – Call to Order

1. Roll Call (Reep, Landenberger, Jones, Smith, Mischel):
2. **Approval of 11/12/2025 Minutes:** .....3-6
3. **Amendments and Approval of Agenda:**
4. Comments from Members of the Public: (For Items Not on the agenda):
5. McDowell Dam (Landenberger-Mischel):
  - a. Supplemental Water Supply
    - i. Easement Negotiations (Anderson updated documents provided)
    - ii. OHF Grant application has been submitted and received and is under review (November 2025)/SWC (web grant after OHF determination)
    - iii. EAP Exercise – Updates Underway (Johnson)
    - iv. **Agricultural Land Lease Renewals (Bliss)**
6. Financial Reports (Reep):
  - a. **Balance Sheet 11/30/2025**.....7-9
  - b. **P&L 11/30/2025** ..... 10-11
7. Drainage Permits/Complaints/Issues: *Open*:
  - a. River Road – Box Culvert and Channel Cleanout (Pending)
  - b. Keelboat Park
    - i. Easement research – Response to DWR Pending
  - c. Hawk Tree HOA – Private Culvert Placement, SWMP Compliance no County Jurisdiction
    - i. LIDAR Elevation Profiles – Memo pending discussion with HOA
8. Drainage Permits/Complaints/Issues: *Closed*:
9. Projects:
  - a. Hoge Island Stabilization:
    - i. Access Easement Revisions (Winter 2025)
    - ii. David Tschider – Maintenance on Section 32 Structure and New Stabilization Area
      1. Should Review permit applications – request and approve work in easement
      2. Investigation – Survey and Soil Bearings
      3. NDDWR Section 32 – Request Letter .....12-14
  - b. Apple Creek U-Mary Slide – Emergency Action Plan (Smith)
    - i. Braun/BGC - instrumentation installed – Monitoring
    - ii. HMGP Quarterly Progress Report – Due January 16, 2026
    - iii. Reimbursement Request Submitted
  - c. Burnt Creek Grass Seeding (Jones)
  - d. MRCC Proposed work (Johnson).....15-20
10. Other Old Business:
  - a. Burleigh County CRS (Placed on hold)
  - b. Burleigh County Commission potential withdrawal from Garrison Diversion Conservancy District

- 11. New Business:
  - a. **2026 Proposed Meeting Dates** ..... **21**
  - b. Annual Levee Inspections ..... 22-38
- 12. Correspondence or Document Information:
  - a. Plats & SWMP's – Not included due to size...Available on request.
    - i. Silver Ranch Fifth Addition
    - ii. Spring Coulee Subdivision Replat
    - iii. Kuntz Subdivision Final Plat
    - iv. Silver Ranch Third Addition Second Replat
- 13. Approval of Bills (Pending).....39**
- 14. Detailed Bills .....40-100
- 15. Adjourn for Executive Session to consult with District legal counsel regarding easement negotiations for McDowell Dam project pursuant to N.D.C.C. 44-04-19.2
- 16. Next Meeting: Wednesday, January 14, 2026, 8:00 AM, Tom Baker Room
- 17. Adjourn

**Note: Bold Items Require Board Action**

---



BCWRD Meeting Minutes  
November 12, 2025  
Draft - Not Approved Yet

Agenda Items	Discussion	Board Action	Responsible Party(s)	Due Date
--------------	------------	--------------	----------------------	----------

**Present:** James Landenberger; Roger Smith (via phone); Dennis Reep; Kathleen Jones; Chuck Mischel; Travis Johnson and Nic Cullen, Houston Engineering; Dave Bliss, Bliss Law Firm; Wendy Egli, Fronteer Professional Services; Jerry Woodcox, Burleigh County Commissioner;  
**Others Present:** Dave Robinson and Dave Mayer (Bismarck Parks & Rec), Casey Einrem, Burleigh County Highway Dept; Mitch Flanagan, Burleigh County Planning & Zoning; Wade Bachmeier, Missouri River Joint Water Board

Chairman Landenberger called the meeting to order at 8:00 am. Roll call was taken, and a quorum was declared.

	Discussion	Action Taken	Responsible Party(s)	Due Date
Approval of 10/08/2025 Minutes		It was moved by Manager Jones, seconded by Manager Reep, and unanimously carried to approve the minutes of the October 8, 2025 meeting as presented.		
Amendments and Approval of Agenda	No Changes	It was moved by Manager Reep, seconded by Manager Jones, and unanimously carried to approve the agenda as presented.		
Comments from Members of the Pubic	None			
McDowell Dam				
Supplemental Water Supply Easement Negotiations	A meeting was held with the remaining landowner. The documents were updated after the meeting and are waiting to be delivered. The landowner is out of state until the end of the month. Discussion was had on how to deliver the document to him. Travis Johnson from Houston Engineering will reach out to him.			
OHF Grant	Grant has been submitted.			
EAP Exercise	EAP exercise was completed on October 28 <sup>th</sup> . Discussion was had about the results and who is to be contacted. Those that are responsible should be familiar with the EAP and what their role is. Travis is updating the contacts and will make sure that Dave Robinson from McDowell Dam is on the list to receive a copy.			
Agricultural Land Lease Renewals	Attorney Bliss and Manager Mischel are working on contacting the Lessees regarding renewals of the leases.			

Agenda Items	Discussion	Board Action	Responsible Party(s)	Due Date
<b>Financial Reports</b>				
<b>Financials</b>				
<b>Balance Sheet</b>	Manager Reep went over the income for the month and the balances in the checking and reserve accounts.	A motion was made by Manager Reep and seconded by Manager Jones, to approve the Balance Sheet as presented. Upon roll call vote, the motion carried unanimously.		
<b>Profit &amp; Loss</b>	None Noted	A motion was made by Manager Reep and seconded by Manager Jones, to approve the Profit & Loss Statement as presented. Upon roll call vote, the motion carried unanimously.		
<b>Release of Pledged Securities</b>	Bravera is asking for us to release excess pledged securities.	A motion was made by Manager Reep and seconded by Manager Jones, to approve the release of pledged securities. Upon roll call vote, the motion carried unanimously.		
<b>2024 Audit</b>	The confidential draft report of the audit was sent to all board members. No action needed. Audit should be finalized soon.			
<b>Drainage Permits/Complaints/Issues: Open</b>				
	River Road – Box Culvert and Channel Cleanout This should be completed soon per Casey Einrem, BCHD			
	Keelboat Park – No updates			
	Hawktree HOA – Casey Einrem with Burleigh County Highway Department updated and informed the board that the Highway Department was contacted by the Engineer for the HOA and they are working on updating the storm water management plan over the winter for work to be completed next year.			
	Mike Koch – No updates			
<b>Drainage Permits/Complaints/Issues: Closed</b>				
	Chase Dewitz – Close			

Agenda Items	Discussion	Board Action	Responsible Party(s)	Due Date
<b>Projects</b>				
<b>Hoge Island Stabilization</b>				
<b>Access Easement Revisions</b>	No updates			
<b>David Tschider</b>	Mr. Johnson updated the board that Mr. Tschider is waiting to hear from the Corps and the state.			
<b>Apple Creek U-Mary Slide</b>				
<b>HMGP Quarterly Report on Progress</b>	Quarterly Report is in the packet for review			
<b>Reimbursement Request</b>	This has been submitted			
<b>Other Old Business</b>				
<b>Burleigh County CRS</b>	Still being reviewed. This process will most likely have to start over once the ETA is released by the city.			
<b>New Business</b>				
<b>Burleigh County Commission withdrawing from Garrison Diversion Conservancy District</b>	<p>Discussion was held regarding this. Commissioner Woodcox asked the Board to pass a resolution to be forwarded to the County Auditor stating that the Board supports the Garrison Diversion Conservancy District.</p> <p>Wade Bachmeier with the Missouri River Joint Board was in attendance and asked the Board if they have a problem with the Joint Board sending the letters written by Ken Royse to the County Commissioners.</p>	<p><b>A motion was made by Manager Smith and seconded by Manager Jones, to submit a resolution stating the Board's support in continued membership in the Garrison Diversion Conservancy District. Upon roll call vote, the motion carried unanimously.</b></p> <p><b>The Board has no problem with this.</b></p>		
<b>ND Water Users Meeting</b>	All Managers will be in attendance			
<b>Correspondence or Document Information</b>	Plat & SWMP's are not included in the agenda packet due to size. These are available upon request.			
<b>Approval of Bills</b>	Bills totaling \$136,226.71 are presented.	It was moved by Manager Reep, seconded by Manager Jones, to approve the bills as presented. Upon roll call vote, the motion carried unanimously.		

Agenda Items	Discussion	Board Action	Responsible Party(s)	Due Date
<b>Next Meeting</b>	The next meeting of the Burleigh County Water Resource District will be held on Tuesday, December 8, 2025, at 8:00 a.m. in the Tom Baker Room located at 221 N 5 <sup>th</sup> Street, Bismarck, ND.			

There being no further business to be considered by the Board, Chairman Landenberger adjourned the meeting at 9:14 a.m.  
Wendy Egli, BCWRD Admin. Secretary

## Balance Sheet

As of November 30, 2025

	Nov 30, 25
<b>ASSETS</b>	
Current Assets	
Checking/Savings	
10900 · Bravera Bank Center Checking	1,739,272.71
10950 · Designated Reserve Funds	700,443.26
10980 · Bravera Wealth Fund	2,474,834.46
Total Checking/Savings	4,914,550.43
Other Current Assets	
11010 · Taxes Receivable	13,208.28
Total Other Current Assets	13,208.28
Total Current Assets	4,927,758.71
Fixed Assets	
15005 · Land	112,481.50
15010 · Infrastructure	6,679,992.53
15015 · Land Improvements	1,822,773.62
15020 · Buildings	202,450.43
15025 · Office Furniture & Equipment	207,082.57
15051 · Acc Depr - Infrastructure	-889,503.06
15052 · Acc Depr - Land Improvements	-1,221,170.33
15053 · Acc Depr - Building	-156,945.38
15054 · Acc Depr - Office Furn & Equip	-150,038.42
Total Fixed Assets	6,607,123.46
Other Assets	
11100 · Certified Special Assess Rec'bl	119,767.12
11150 · Uncertified Special Assess Rec	1,656,758.73
Total Other Assets	1,776,525.85
<b>TOTAL ASSETS</b>	<b>13,311,408.02</b>
<b>LIABILITIES &amp; EQUITY</b>	
Liabilities	
Current Liabilities	
Accounts Payable	
20000 · Accounts Payable	218,808.22
Total Accounts Payable	218,808.22
Other Current Liabilities	
24001 · Accrued Payroll Taxes	853.60
Total Other Current Liabilities	853.60
Total Current Liabilities	219,661.82
Long Term Liabilities	
23200 · Rehab Apple Valley Waste Water	105,000.00
237 · Burnt Creek Floodway	210,000.00
23750 · Hogue Island	455,000.00
23800 · Missouri River Correctional Cen	210,000.00
23900 · Fox Island Improvement	1,080,000.00
25000 · Bond Discount	-20,280.00
Total Long Term Liabilities	2,039,720.00
Total Liabilities	2,259,381.82

Burleigh County Water Resource District (BCWRD)

Balance Sheet

As of November 30, 2025

	Nov 30, 25
Equity	
32000 · Retained Earnings	10,392,532.28
Net Income	659,493.92
Total Equity	11,052,026.20
TOTAL LIABILITIES & EQUITY	13,311,408.02

**Burleigh County Water Resource District (BCWRD)**  
**Designated Funds Breakdown**  
**November 30, 2025**

O&M Funds

Brookfield Estates	\$ 2,963.74	
Burnt Creek	\$ 78,947.56	
Country Creek	\$ 3,304.34	
Fox Island	\$ 34,805.11	
Hogue Island	\$ -	
Total O&M Funds		\$120,020.75

Special Assessment Districts

Apple Valley	\$ 9,562.85	
Fox Island	\$ 55,426.03	
Hogue Island	\$170,076.17	
MRCC	\$ (2,814.40)	
Total Special Assessment Funds		\$232,250.65

Burnt Creek Capital	\$ 25,000.00
McDowell Dam Capital Improvement	\$200,000.00
McDowell Dam Fresh Water Intake	\$550,000.00
Missouri River Bank Stabilization	\$100,000.00

Total Designated Funds	<u><u>\$1,227,271.40</u></u> *
------------------------	--------------------------------

\*These funds are held in either the Designated Reserve fund or the Bravera Wealth Fund

Burleigh County Water Resource District (BCWRD)  
Profit & Loss by Class  
January through November 2025

	TOTAL	- General	Apple Valley	Brookfield Est.	Burnt Creek Floodway	Country Ridge/Creek	Fox Island	Hoge Island	McDowell Dam	MRCC	Sibley Island	TOTAL
Income												
31110 · Real Estate Tax	949,707.88	949,707.88	0.00	0.00	0.00	0.00	0.00	0.00	0.00	0.00	0.00	949,707.88
36110 · Interest	133,880.32	133,880.32	0.00	0.00	0.00	0.00	0.00	0.00	0.00	0.00	0.00	133,880.32
36210 · McDowell Dam Recreation Income	19,114.95	0.00	0.00	0.00	0.00	0.00	0.00	0.00	19,114.95	0.00	0.00	19,114.95
43610 · State Aid Distribution	47,661.17	47,661.17	0.00	0.00	0.00	0.00	0.00	0.00	0.00	0.00	0.00	47,661.17
43810 · Reimbursements	564,654.33	126,683.98	11,829.10	49.70	60,041.39	46.27	108,164.26	209,724.18	20,793.80	27,321.65	0.00	564,654.33
46910 · Misc Revenue	47,252.39	1,097.00	0.00	0.00	0.00	0.00	0.00	0.00	46,155.39	0.00	0.00	47,252.39
Total Income	1,762,271.04	1,259,030.35	11,829.10	49.70	60,041.39	46.27	108,164.26	209,724.18	86,064.14	27,321.65	0.00	1,762,271.04
Gross Profit	1,762,271.04	1,259,030.35	11,829.10	49.70	60,041.39	46.27	108,164.26	209,724.18	86,064.14	27,321.65	0.00	1,762,271.04
Expense												
111 · Payroll Expenses												
111A · Wages/Stipends	22,617.00	22,617.00	0.00	0.00	0.00	0.00	0.00	0.00	0.00	0.00	0.00	22,617.00
111B · Payroll Taxes	1,876.89	1,876.89	0.00	0.00	0.00	0.00	0.00	0.00	0.00	0.00	0.00	1,876.89
111C · Workforce Safety & Insurance	250.00	250.00	0.00	0.00	0.00	0.00	0.00	0.00	0.00	0.00	0.00	250.00
111D · Payroll Processing Fees	400.00	400.00	0.00	0.00	0.00	0.00	0.00	0.00	0.00	0.00	0.00	400.00
Total 111 · Payroll Expenses	25,143.89	25,143.89	0.00	0.00	0.00	0.00	0.00	0.00	0.00	0.00	0.00	25,143.89
113 · Accounting & Contract Services	25,850.00	25,850.00	0.00	0.00	0.00	0.00	0.00	0.00	0.00	0.00	0.00	25,850.00
114 · Audit	8,089.61	8,089.61	0.00	0.00	0.00	0.00	0.00	0.00	0.00	0.00	0.00	8,089.61
312 · Legal Fees	15,044.80	15,044.80	0.00	0.00	0.00	0.00	0.00	0.00	0.00	0.00	0.00	15,044.80
315 · Engineering Administration	20,669.25	20,669.25	0.00	0.00	0.00	0.00	0.00	0.00	0.00	0.00	0.00	20,669.25
328 · Liability Insurance	7,661.00	7,661.00	0.00	0.00	0.00	0.00	0.00	0.00	0.00	0.00	0.00	7,661.00
341 · Travel	392.47	392.47	0.00	0.00	0.00	0.00	0.00	0.00	0.00	0.00	0.00	392.47
376 · Dues & Publications	1,525.00	1,525.00	0.00	0.00	0.00	0.00	0.00	0.00	0.00	0.00	0.00	1,525.00
411 · Office Expense	7,960.19	7,960.19	0.00	0.00	0.00	0.00	0.00	0.00	0.00	0.00	0.00	7,960.19
415 · Bank Fees	4,156.92	4,156.92	0.00	0.00	0.00	0.00	0.00	0.00	0.00	0.00	0.00	4,156.92
50913 · Interest Expense	48,501.01	0.00	3,000.00	0.00	6,300.00	0.00	15,717.50	17,921.01	0.00	5,562.50	0.00	48,501.01
904 · McDowell Dam	249,944.92	0.00	0.00	0.00	0.00	0.00	0.00	0.00	249,944.92	0.00	0.00	249,944.92
905 · McDowell Dam-Capital Improvemen												
905-A · Fresh Water Intake	60,015.75	0.00	0.00	0.00	0.00	0.00	0.00	0.00	60,015.75	0.00	0.00	60,015.75
905 · McDowell Dam-Capital Improvemen - Other	310,946.25	7,202.75	0.00	0.00	0.00	0.00	0.00	0.00	303,743.50	0.00	0.00	310,946.25
Total 905 · McDowell Dam-Capital Improvemen	370,962.00	7,202.75	0.00	0.00	0.00	0.00	0.00	0.00	363,759.25	0.00	0.00	370,962.00
910 · Projects												
Administration	3,320.00	0.00	600.00	0.00	1,095.00	0.00	530.00	0.00	0.00	1,095.00	0.00	3,320.00
Legal Fees	7,299.60	94.80	0.00	0.00	0.00	0.00	0.00	284.40	6,920.40	0.00	0.00	7,299.60
O&M	6,200.00	6,200.00	0.00	0.00	0.00	0.00	0.00	0.00	0.00	0.00	0.00	6,200.00
Total 910 · Projects	16,819.60	6,294.80	600.00	0.00	1,095.00	0.00	530.00	284.40	6,920.40	1,095.00	0.00	16,819.60
920 · Continuing Education	1,090.00	1,090.00	0.00	0.00	0.00	0.00	0.00	0.00	0.00	0.00	0.00	1,090.00
932 · City/County Watershed Planning	222,283.39	222,283.39	0.00	0.00	0.00	0.00	0.00	0.00	0.00	0.00	0.00	222,283.39
933 · Missouri River General Services	12,690.25	12,690.25	0.00	0.00	0.00	0.00	0.00	0.00	0.00	0.00	0.00	12,690.25
934 · Missouri River Bank Stabilizati	6,725.25	6,725.25	0.00	0.00	0.00	0.00	0.00	0.00	0.00	0.00	0.00	6,725.25
937 · Design/Special Assessment	2,935.00	0.00	0.00	0.00	0.00	0.00	0.00	403.50	0.00	0.00	2,531.50	2,935.00
940 · Operations & Maintenances	19,984.82	2,528.15	0.00	0.00	16,616.67	0.00	420.00	0.00	0.00	420.00	0.00	19,984.82
941 · Stream Gages	4,646.75	4,646.75	0.00	0.00	0.00	0.00	0.00	0.00	0.00	0.00	0.00	4,646.75
960 · Drainage Complaints	28,815.55	28,815.55	0.00	0.00	0.00	0.00	0.00	0.00	0.00	0.00	0.00	28,815.55
970 · Storm Water Management Plans	885.45	885.45	0.00	0.00	0.00	0.00	0.00	0.00	0.00	0.00	0.00	885.45
Total Expense	1,102,777.12	409,655.47	3,600.00	0.00	24,011.67	0.00	16,667.50	18,608.91	620,624.57	7,077.50	2,531.50	1,102,777.12
Net Income	659,493.92	849,374.88	8,229.10	49.70	36,029.72	46.27	91,496.76	191,115.27	-534,560.43	20,244.15	-2,531.50	659,493.92



10:30 AM

12/05/25

Accrual Basis

## Burleigh County Water Resource District (BCWRD)

## Profit &amp; Loss Budget vs. Actual

January through November 2025

	Jan - Nov 25	Budget	\$ Over Budget	% of Budget
<b>Income</b>				
31110 · Real Estate Tax	949,707.88	1,014,000.00	-64,292.12	93.7%
31810 · In Lieu of Tax	0.00	500.00	-500.00	0.0%
33620 · Homestead Credit	0.00	0.00	0.00	0.0%
36110 · Interest	133,880.32	50,000.00	83,880.32	267.8%
36210 · McDowell Dam Recreation Income	19,114.95	25,000.00	-5,885.05	76.5%
36215 · McDowell Dam Land Lease	0.00	3,200.00	-3,200.00	0.0%
43610 · State Aid Distribution	47,661.17	50,000.00	-2,338.83	95.3%
43810 · Reimbursements	564,654.33			
46910 · Misc Revenue	47,252.39	500.00	46,752.39	9,450.5%
<b>Total Income</b>	<b>1,762,271.04</b>	<b>1,143,200.00</b>	<b>619,071.04</b>	<b>154.2%</b>
<b>Gross Profit</b>	<b>1,762,271.04</b>	<b>1,143,200.00</b>	<b>619,071.04</b>	<b>154.2%</b>
<b>Expense</b>				
111 · Payroll Expenses				
111A · Wages/Stipends	22,617.00	30,000.00	-7,383.00	75.4%
111B · Payroll Taxes	1,876.89	3,000.00	-1,123.11	62.6%
111C · Workforce Safety & Insurance	250.00			
111D · Payroll Processing Fees	400.00			
<b>Total 111 · Payroll Expenses</b>	<b>25,143.89</b>	<b>33,000.00</b>	<b>-7,856.11</b>	<b>76.2%</b>
113 · Accounting & Contract Services	25,850.00	32,000.00	-6,150.00	80.8%
114 · Audit	8,089.61	10,000.00	-1,910.39	80.9%
312 · Legal Fees	15,044.80	24,000.00	-8,955.20	62.7%
315 · Engineering Administration	20,669.25	24,000.00	-3,330.75	86.1%
328 · Liability Insurance	7,661.00	6,000.00	1,661.00	127.7%
341 · Travel	392.47	2,000.00	-1,607.53	19.6%
376 · Dues & Publications	1,525.00	5,000.00	-3,475.00	30.5%
411 · Office Expense	7,960.19	3,000.00	4,960.19	265.3%
415 · Bank Fees	4,156.92			
50913 · Interest Expense	48,501.01			
904 · McDowell Dam	249,944.92	330,000.00	-80,055.08	75.7%
905 · McDowell Dam-Capital Improvemen				
905-A · Fresh Water Intake	60,015.75	100,000.00	-39,984.25	60.0%
905 · McDowell Dam-Capital Improvemen - Other	310,946.25	150,000.00	160,946.25	207.3%
<b>Total 905 · McDowell Dam-Capital Improvemen</b>	<b>370,962.00</b>	<b>250,000.00</b>	<b>120,962.00</b>	<b>148.4%</b>
910 · Projects				
Administration	3,320.00			
Legal Fees	7,299.60			
O&M	6,200.00			
910 · Projects - Other	0.00	156,200.00	-156,200.00	0.0%
<b>Total 910 · Projects</b>	<b>16,819.60</b>	<b>156,200.00</b>	<b>-139,380.40</b>	<b>10.8%</b>
911 · Misc	0.00	1,000.00	-1,000.00	0.0%
920 · Continuing Education	1,090.00			
932 · City/County Watershed Planning	222,283.39			
933 · Missouri River General Services	12,690.25	20,000.00	-7,309.75	63.5%
934 · Missouri River Bank Stabilizati	6,725.25			
937 · Design/Special Assessment	2,935.00	200,000.00	-197,065.00	1.5%
940 · Operations & Maintenances	19,984.82	20,000.00	-15.18	99.9%
941 · Stream Gages	4,646.75	7,000.00	-2,353.25	66.4%
960 · Drainage Complaints	28,815.55	20,000.00	8,815.55	144.1%
970 · Storm Water Management Plans	885.45			
<b>Total Expense</b>	<b>1,102,777.12</b>	<b>1,143,200.00</b>	<b>-40,422.88</b>	<b>96.5%</b>
<b>Net Income</b>	<b>659,493.92</b>	<b>0.00</b>	<b>659,493.92</b>	<b>100.0%</b>



# **Burleigh County Water Resource District**

**PO Box 1255**

**Bismarck, North Dakota 58502-1255**

**(701) 354-1501**

**[www.bcwrdd.org](http://www.bcwrdd.org)**

December 9, 2025

Reice Haase, Director  
North Dakota Department of Water Resources  
1200 Memorial Highway, Dept 770  
Bismarck, North Dakota 58504

Re: Hoge Island Bank Stabilization – USACE Windrow Revetment RM 1323.6

Dear Mr. Haase:

On July 28, 1976, the Burleigh County Water Management Board (a.k.a. Burleigh County Water Resource District, BCWRD) signed an agreement with the North Dakota State Water Commission, (Commission). This agreement was related to federal revetments constructed by the United States Army Corps of Engineers (USACE) under *Section 32 Streambank Erosion Control Evaluation and Demonstration Act 1974* (Public Law 93-251) on easements provided by the BCWRD. This agreement contains the following statements under Article III, IV, V and VI:

*“... III*

*That the Commission shall maintain and operate the project after completion in accordance with the regulations prescribed by the Secretary of the Army*

*IV*

*That the Commission and the District shall share equally the actual cost of maintaining and operating the project.*

*V*

*Therefore incurring any maintenance or operation expenses the Commission shall provide the District with an itemized statement of all such expenses.*

*VI*

*That within one year of the receipt of such itemized statement the District shall remit its share of such expenses to the Commission. ....”*

During the summer of 2025, upper bank settlement was noted by the landowners on the Section 32 windrow revetment located at approximately River Mile 1323.6, at the north end of Hoge Island, also located at the residential address 10054 Island Road. Several follow-up site visits by the BCWRD along with the NDDWR staff, and landowners documented this settlement area has been expanding and there are concerns if this situation is not addressed, it could propagate, resulting in further damage to the revetment and potentially adjacent residential property.

---

**Current Board Members:**

**James Landenberger, Chairman 701-426-6439    Roger Smith, Vice Chairman 701-400-6283**  
**Dennis Reep, Secretary/Treasurer 701-595-2142    Kathleen Jones, Manager 701-400-7129**  
**Chuck Mischel, Manager 701-220-5484**

Reice Haase, NDDWR Director

Re: Hoge Island Bank Stabilization – USACE Windrow Revetment RM 1323.8

December 9, 2025

Page -2-

Pursuant to discussions with NDDWR staff this letter is formal request to the North Dakota State Water Commission regarding funds to participate in the cost to conduct the initial investigation and site evaluation, to determine the likely cause and best methods to restore or rehabilitate the Section 32 structure, as noted under the O&M Agreement.

We understand this request is below the Director's limits to approve and would not need to go to the SWC subcommittee for review, unless you determine that is necessary. Based on what we know today the initial investigation and site evaluation budget is estimated at \$37,000, with 50% of these costs, \$18,500, to be invoiced to the NDDWR on completion. Actual costs are dependent on the final costs incurred. The investigation and evaluation will include a determination of the cause and recommendations related to the remediation measures and implementation expenses.

We are willing to meet with you or staff at your convenience to further discuss the request. Given the time of year and pending ice-in conditions in mid-December need and will complete the river bathymetric survey. With your approval we will then continue with the geotechnical exploration and site evaluation on what appears to be a rotational bank failure.

Respectfully,

James Landenberger, Chairman

Enclosure

C: John Paczkowski, ND State Engineer (email)  
Amy Winkelman, ND Sovereign Land Coordinator (email)  
Aaron Carranza, Clay Carufel, Amy Winkleman - NDDWR (email)  
Bismarck Regulatory Office USACE  
David Bliss, Bliss Law (email)  
Michael H. Gunsch, Houston Engineering, Inc. (email)  
BCWRD Board Members (email)  
David Tschider, Landowner

---

**Current Board Members:**

James Landenberger, Chairman 701-426-6439    Roger Smith, Vice Chairman 701-400-6283  
Dennis Reep, Secretary/Treasurer 701-595-2142    Kathleen Jones, Manager 701-400-7129  
Chuck Mischel, Manager 701-220-5484

**From:** Michael Gunsch <mgunsch@houstoneng.com>  
**Sent:** Wednesday, December 03, 2025 1:37 PM  
**To:** Secretary Wendy Egle; James Landenberger; Roger Smith  
**Cc:** Travis Johnson  
**Subject:** David Tschider - Section 32  
**Attachments:** Dec 9, 2025 Tschider NDDWR Section 32 Request.docx

James and Roger

See attached letter for the agenda book.

This is the Section 32 request that addresses the David Tschider property.

The \$37,000 includes a \$17,000 expense from Braun Intertec to conduct a boring and soils testing to determine the depth of the failure and options for stabilization. We have discussed unloading the upper bank as well as sheet pile, but unsure of the end point. There appears to have been soils placed in this area, but we will need to complete a topographic lidar review to determine the changes that occurred.

This movement appears to have been around a while, though according to Wes there appear to be multiple slide zones within this failure. So, more reviews are necessary. There is also an alternative to consider after the boring and that is to unload the bank within the 100 foot set back.

More at the meeting, and while there is a concern about ice conditions, we are looking into those elevations to determine a potential risk level. Travis has been following this issue so will be available to speak to the issue and questions. More to come, but the letter gets things moving from the DWR level. They feel the BCWRD is best equipped to address the issue in a more expedient manner.

Thanks,

**Michael Gunsch, PE\*, CFM**

Senior Civil Engineer

📞 701.323.0200 | 📠 701.751.6277 | 📠 701.527.2134



*\*Licensed in ND*

This message shall not be construed as official project information or direction except as expressly provided in the contract documents. This entire message (including all forwards and replies) and any attachments are for the sole use of the intended recipient(s) and may contain proprietary, confidential, trade secret, work-product, attorney-client or privileged information. Any unauthorized review, use, disclosure or distribution is prohibited and may be a violation of law. If you are not the intended recipient, please contact the sender by reply email and destroy all copies of the original message.

**From:** Travis Johnson <travis.johnson@houstoneng.com>  
**Sent:** Thursday, November 13, 2025 2:50 PM  
**To:** 'James Landenberger'; Dennis Reep (dwrburleighwrd@gmail.com)  
**Cc:** Michael Gunsch; Wendy Egli  
**Subject:** FW: New Road near the levee - MRCC  
**Attachments:** Screenshot 2025-11-07 094843.png; Pages 19-21 MRCC FLOOD CONTROL PROJECT 4-12-16.pdf

Today I have spoken with Shannon Davison, the new warden for MRCC and it turns out that they are doing some work at that site that will impact our levee and will require us to do some analysis of the impacts. For that I would like to activate the project number 6025-0012 for MRCC for an O&M review of the proposed work. We will likely need to coordinate with them to make any adjustments to their plan so as to avoid impacts to our infrastructure.

They are constructing a new road/trail immediately adjacent to our levee and based on the footprint that Shannon provided, it appears that it would be on top of our toe drain and our cleanout and drain pump basin on the inside of the levee. I have attached the relevant plan sheets from the plan set.

**Travis Johnson**

Senior Civil Engineer

📞 701.323.0200 | 📠 701.751.6287 | 📠 701.226.0227



This message shall not be construed as official project information or direction except as expressly provided in the contract documents. This entire message (including all forwards and replies) and any attachments are for the sole use of the intended recipient(s) and may contain proprietary, confidential, trade secret, work-product, attorney-client or privileged information. Any unauthorized review, use, disclosure or distribution is prohibited and may be a violation of law. If you are not the intended recipient, please contact the sender by reply email and destroy all copies of the original message.

---

**From:** Davison, Shannon L. <sdavison@nd.gov>  
**Sent:** Thursday, November 13, 2025 2:29 PM  
**To:** Travis Johnson <travis.johnson@houstoneng.com>  
**Cc:** Lundstrom, Blaine W. <bwlundstrom@nd.gov>  
**Subject:** New Road near the levee - MRCC

**[External Email]**

---

Hi Travis,

Per our conversation, we are adding a new road near the levee, which will be a dirt road (not paved) for the inmate to used for walking and recreating. I have attached an image of the where there the new roadway is going to be created (in orange on the attached picture). Please let me know if you have any noted concerns or questions.

Thank you,

Shannon Davison

Deputy Warden

701.328-9691 • 701.426.7739 (m) • [sdavison@nd.gov](mailto:sdavison@nd.gov) • [www.docr.nd.gov](http://www.docr.nd.gov)



TRANSFORMING LIVES,  
INFLUENCING CHANGE,  
STRENGTHENING  
COMMUNITY

## We're hiring!

View current openings and apply  
now at [docr.nd.gov/careers](http://docr.nd.gov/careers)  
Some positions pay a \$1k sign on  
bonus or more!



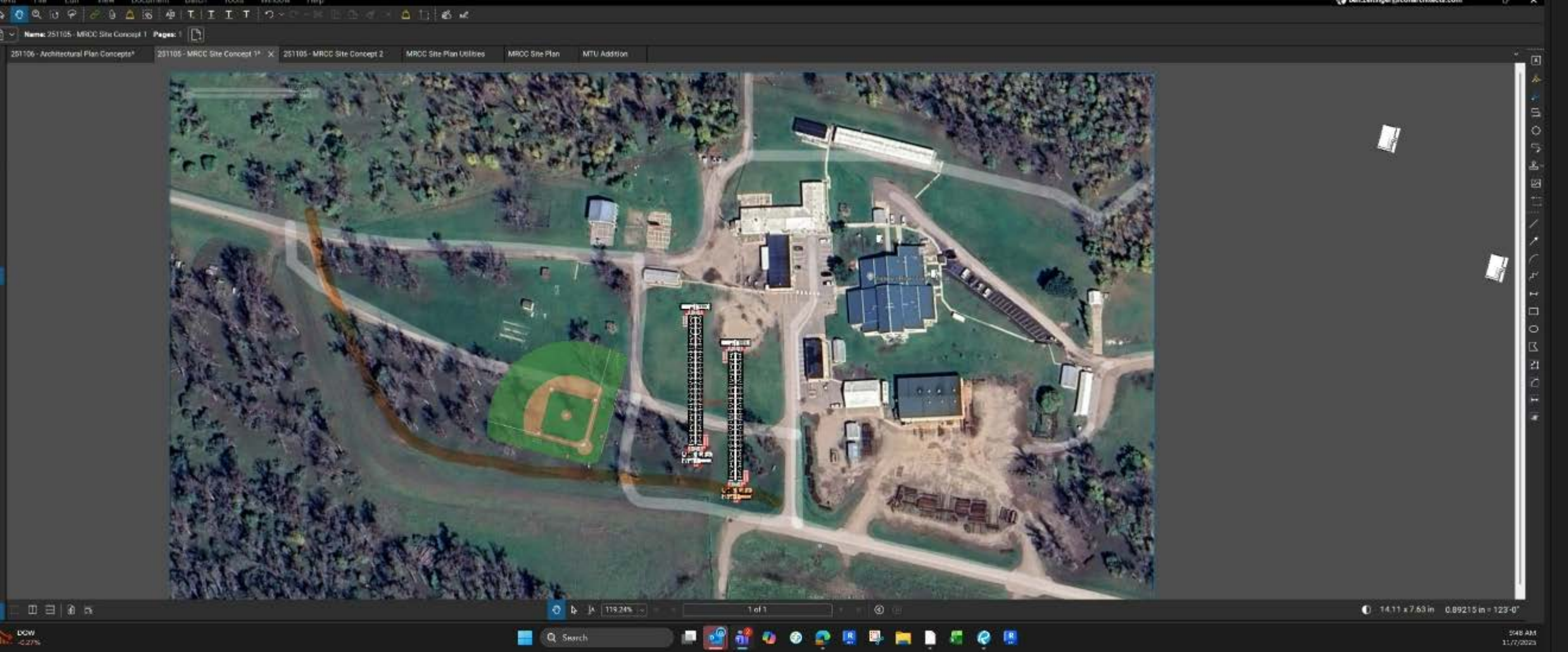

H:\Bismarck\JUN6025\Burleigh Co. WRD 6025-012 MRCC Flood Control\CAD\Plans\Plan & Profile South.dwg P&PS4-4/12/2016 12:52 PM (avistad)

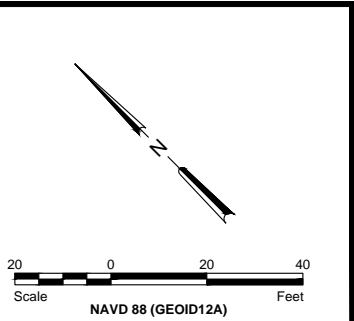
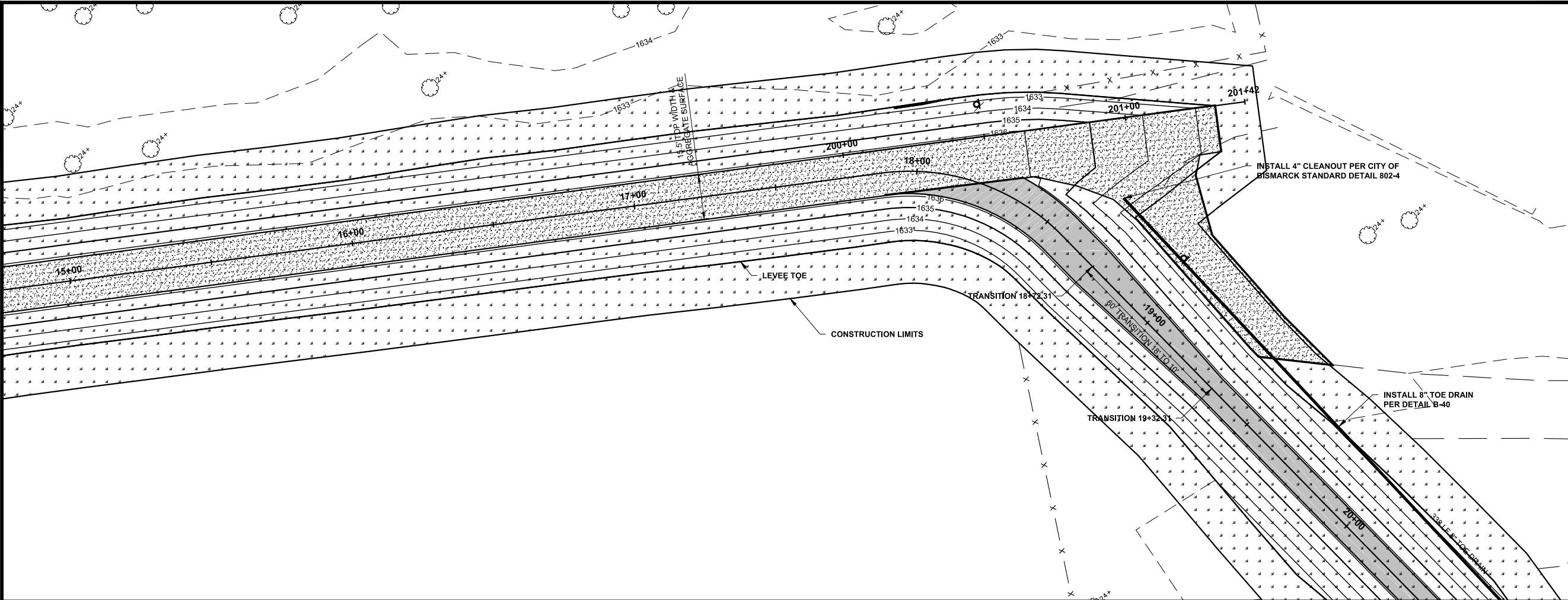

LEGEND

- SEEDING
- AGGREGATE SURFACE
- ASPHALT SURFACE

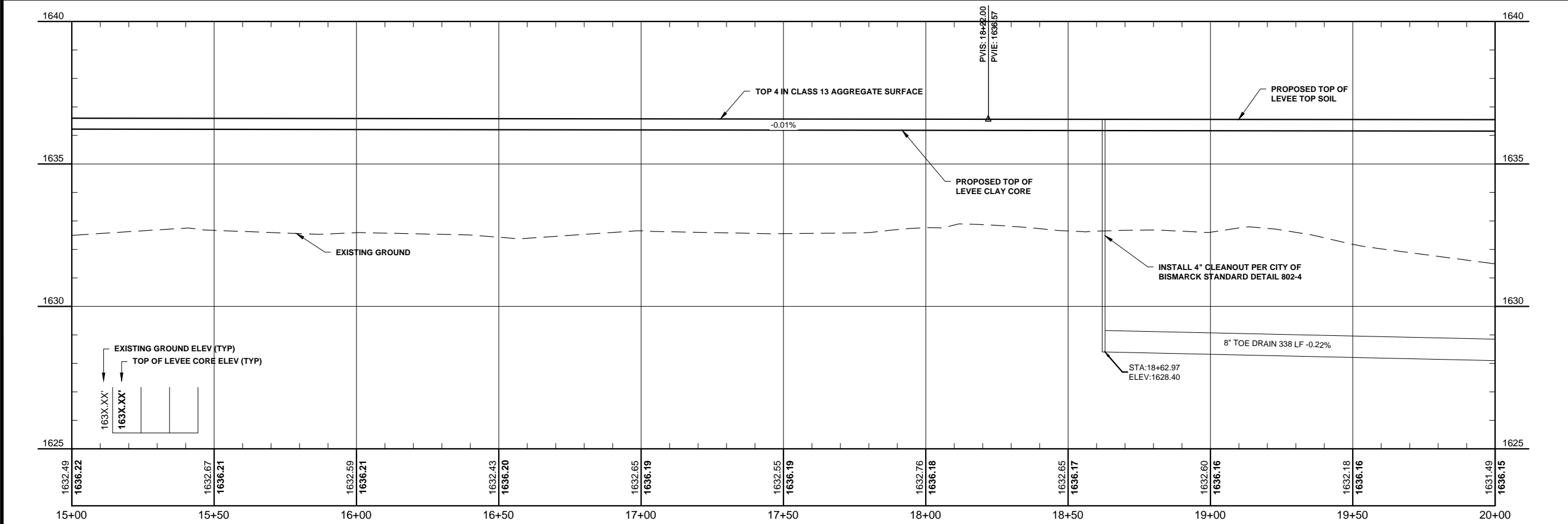

NOTE: PROPOSED TOP OF LEVEE CLAY CORE PROFILE ACCOUNTS FOR 2" OF SETTLEMENT AS CALCULATED BY BRAUN INTERTEC

This document  
is preliminary  
and not for  
construction or  
implementation  
purposes.

				 Houston Engineering Inc.	Bismarck	Drawn by AV	Date 11-3-15	MRCC FLOOD CONTROL PROJECT BURLEIGH COUNTY WATER RESOURCE DISTRICT BURLEIGH COUNTY, NORTH DAKOTA	PLAN & PROFILE SOUTH	SHEET  19 of X
					P: 701.323.0200 F: 701.323.0300	Checked by TGJ	Scale AS SHOWN			
No.	Revision	Date	By							



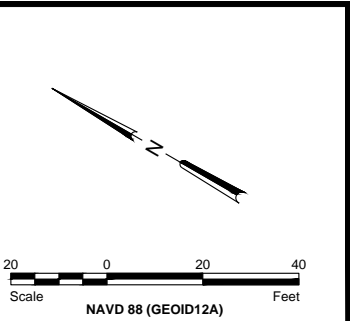
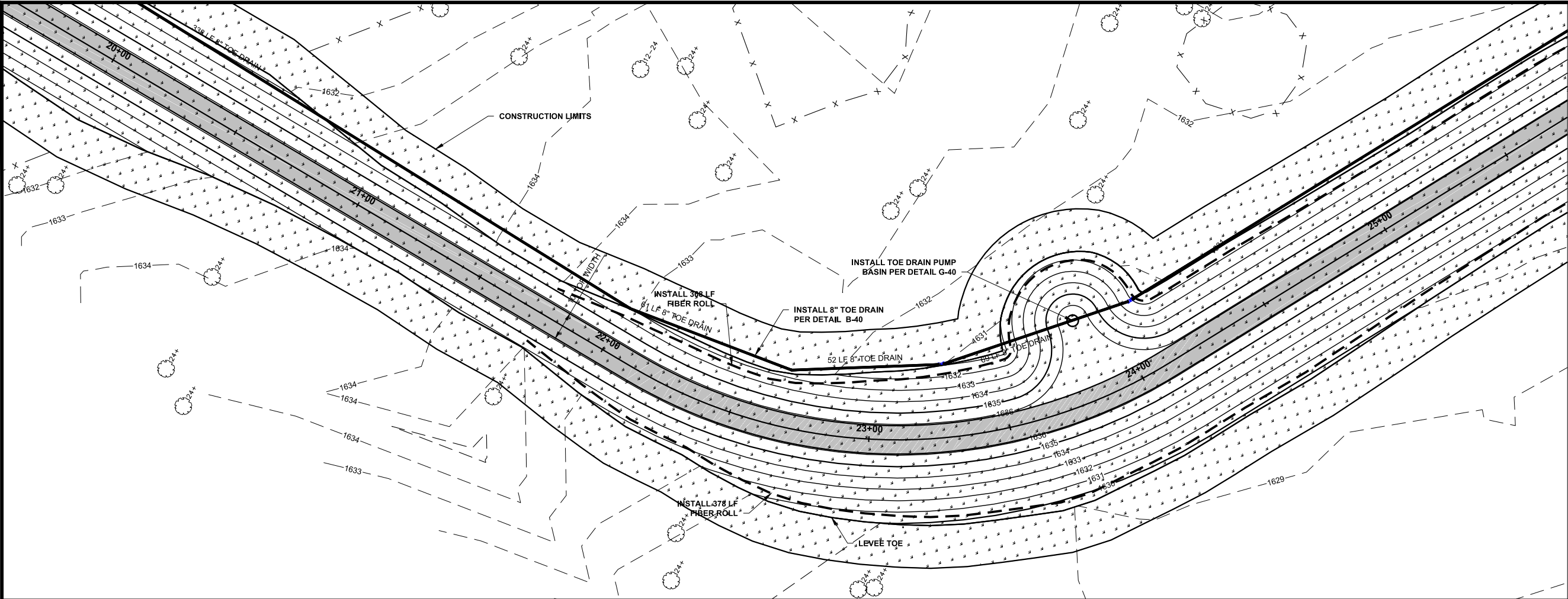

LEGEND

- SEEDING
- AGGREGATE SURFACE
- ASPHALT SURFACE

NOTE: PROPOSED TOP OF LEVEE CLAY CORE PROFILE ACCOUNTS FOR 2" OF SETTLEMENT AS CALCULATED BY BRAUN INTERTEC

This document is preliminary and not for construction or implementation purposes.

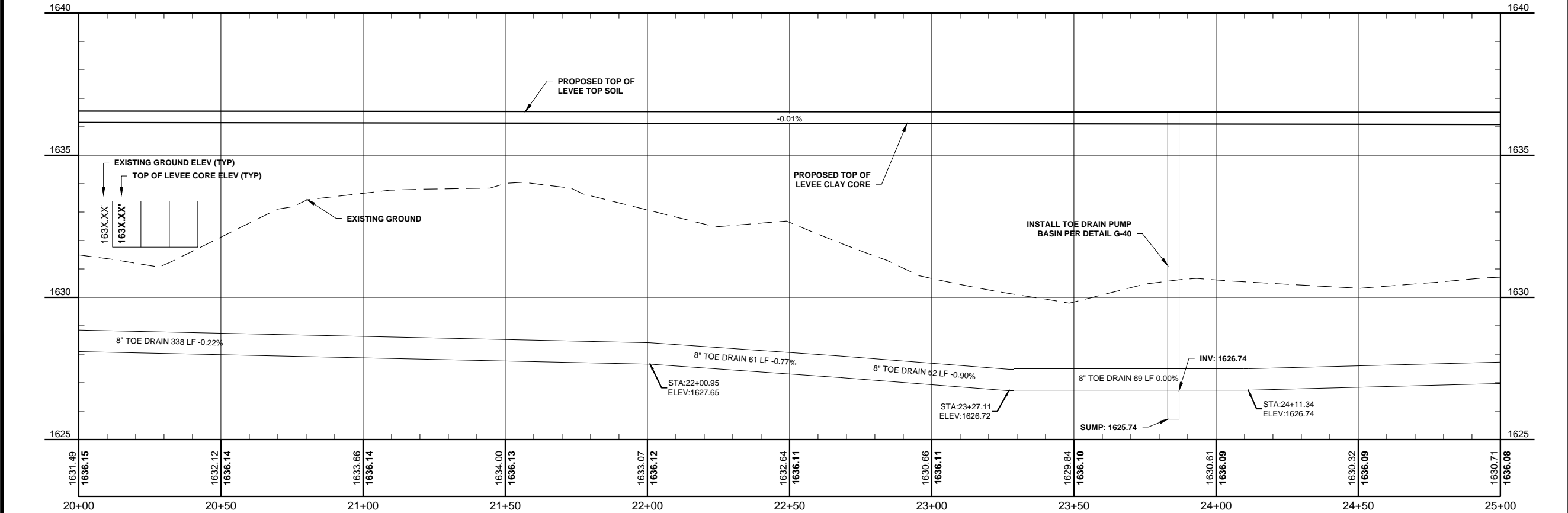

No.	Revision	Date	By



Bismarck	Drawn by AV	Date 11-3-15
P: 701.323.0200 F: 701.323.0300	Checked by TGJ	Scale AS SHOWN

MRCC FLOOD CONTROL PROJECT  
BURLEIGH COUNTY WATER RESOURCE DISTRICT  
BURLEIGH COUNTY, NORTH DAKOTA

PLAN & PROFILE SOUTH  
PROJECT NO. 6025-012

SHEET  
20 of X

H:\Bismarck\JUN\6025 Burleigh Co. WRD\6025-012 MRCC Flood Control\CAD\Plans\Plan & Profile South.dwg P&PS-4/12/2016 12:52 PM-(avstad)

H:\Bismarck\JBN\6025-Burleigh Co. WRD\6025-012 MRCC Flood Control\CAD\Plans\Plan & Profile South.dwg P&PSG-4/12/2016 12:52 PM-(avistad)

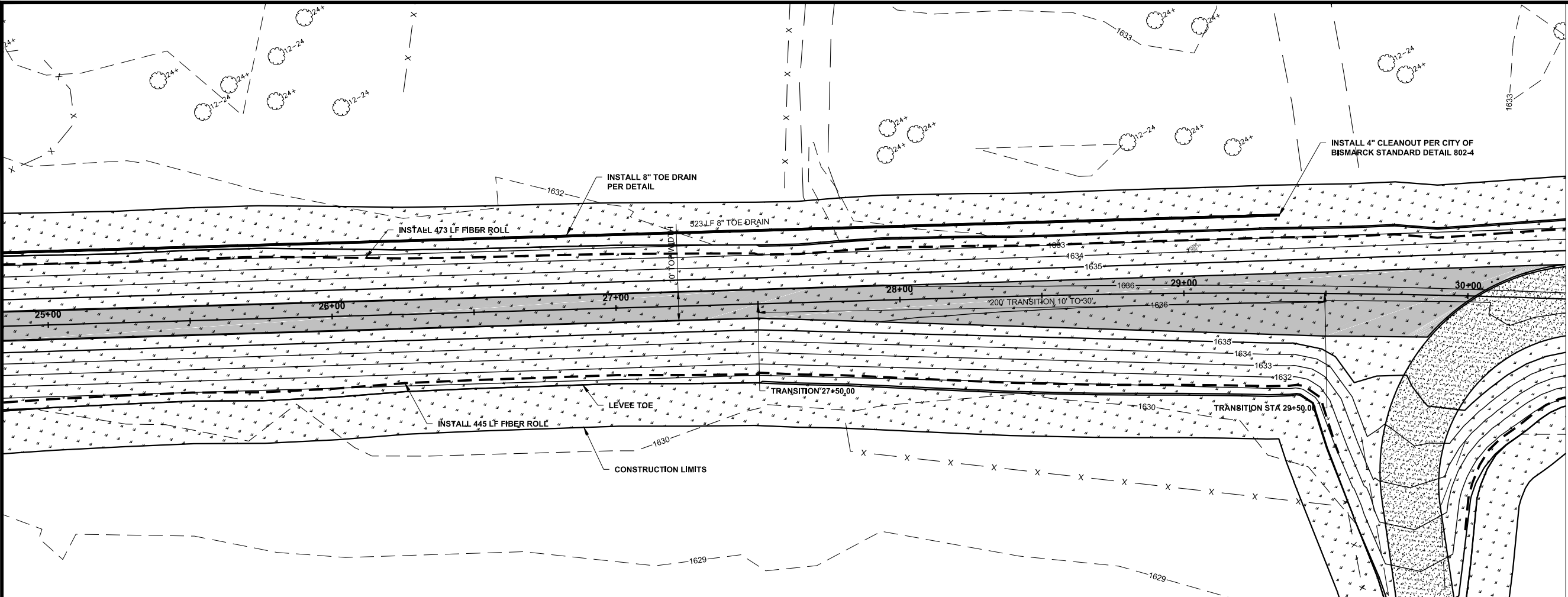

Scale      NAVD 88 (GEOID12A)      Feet

**LEGEND**  
  
SEEDING        
AGGREGATE SURFACE        
ASPHALT SURFACE

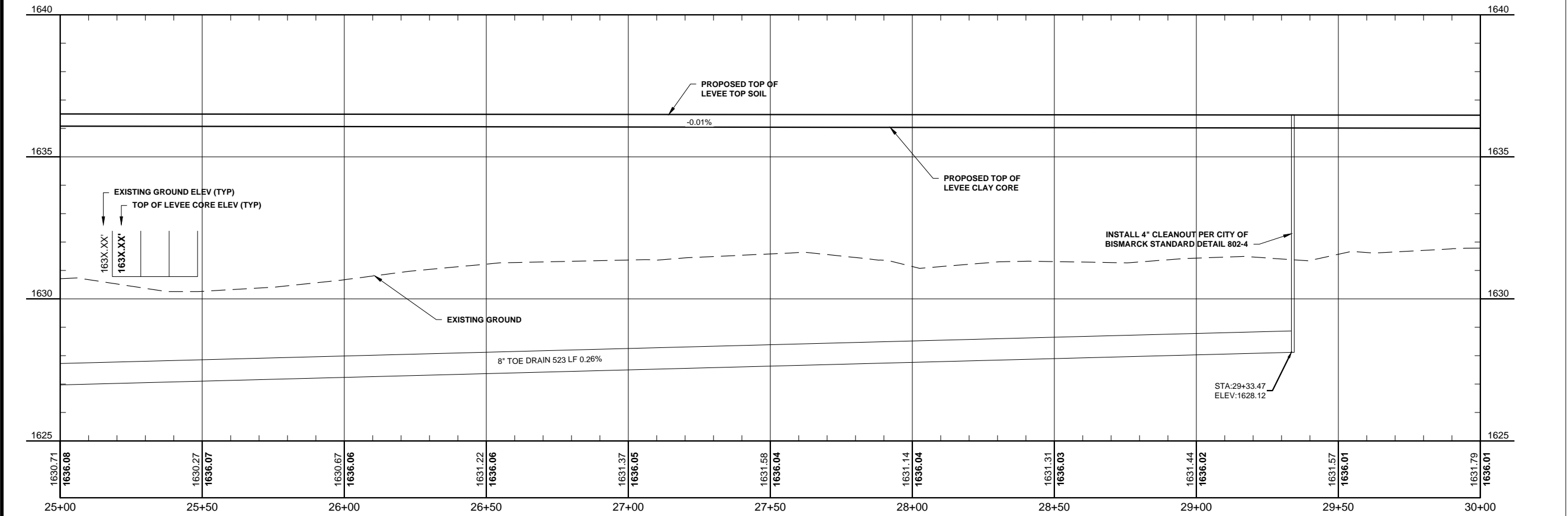

NOTE: PROPOSED TOP OF LEVEE CLAY CORE PROFILE ACCOUNTS FOR 2" OF SETTLEMENT AS CALCULATED BY BRAUN INTERTEC

This document  
is preliminary  
and not for  
construction or  
implementation  
purposes.

*PRELIMINARY*

					 Houston Engineering Inc.	Bismarck	Drawn by AV	Date 11-3-15	MRCC FLOOD CONTROL PROJECT BURLEIGH COUNTY WATER RESOURCE DISTRICT BURLEIGH COUNTY, NORTH DAKOTA	PLAN & PROFILE SOUTH	SHEET  21 of X
						P: 701.323.0200 F: 701.323.0300	Checked by TGJ	Scale AS SHOWN			
No.	Revision	Date	By								

Burleigh County Water Resource District Proposed 2026 Meeting Dates

January 14, 2026

February 11, 2026

March 11, 2026

April 8, 2026

May 13, 2026

June 10, 2026

July 8, 2026

August 12, 2026

September 9, 2026

October 14, 2026

**November 11, 2026 – Need to Change – Veteran's Day**

December 9, 2026

## **Burnt Creek Flood Control Operation & Maintenance Manual Annual Inspection Checklist**

Date Inspected: 11/15/25 Inspected By: Travis Johnson Title: Consultant

Water Level: Normal Accompanied By: N/A Title: \_\_\_\_\_  
(low/normal/high)

Weather Conditions: 50 degrees, Cloudy, breeze

### **Site Observations and Actions**

<b>Dike/Levee</b>	<b>Status</b>	<b>Comments/Location Noted/Actions Required</b>
Erosion	N/A	None Noted
Wave erosion / scarp at waterline	N/A	None Noted
Riprap adequate	Yes	
Grass cover adequate	Yes	Some small bare patches noted
Trees / bushes	Yes	Some small sumac noted on bank
Animal burrows	Yes	Numerous small rodent burrows
Cracks (Earth Levee)	No	
Settlement / depressions	No	
Sinkholes	No	
Slides / bulges	No	
Rutting / tracking	No	
Gate / fence condition	Good	
Signage / notices / postings	Good	
Open / close fence gate	Good	
Additional observations:		
<b>Drop Structures</b>	<b>Status</b>	<b>Comments/Location Noted/Actions Required</b>
Drop structure condition	Good	
Sheet Pile Weir Condition	Good	
Additional observations:		
<b>Channel</b>	<b>Status</b>	<b>Comments/Location Noted/Actions Required</b>
Debris in channel / clogging	Minor	Cattail growth and some small logs
Additional observations:		
<b>Sluice Gates</b>	<b>Status</b>	<b>Comments/Location Noted/Actions Required</b>
Corrosion/Attachment/Condition	Good	
Operate 1804 sluice gates	Good	Gates operate freely
Operate Hoge Island sluice gate	Unk	Not Checked - check on next inspection
Additional observations:		1804 culverts may need cleanout
		Closing gates may require cleanout

1. Recommend filling in and compacting rodent burrows, monitor for new rodent activity. Burrows noted present a very low threat to levee and mowing appears to deter burrowing as no new burrows in mowed area.
2. Recommend seeding bare patches.
3. Gates in good condition.



1. Larger rodent burrows noted. Also a number of much smaller ones.





2. Bare patches noted.





3. Hwy 1804 gates appear to be in excellent condition and operable.







# Fox Island Flood Control Project

## Flood Risk Reduction Annual Levee Inspection Report

Levee Name/Location: Fox Island – Bismarck ND, Burleigh County

Original Construction Project No. 6025-0006 Inspector(s) Travis Jonson

Superintendent: \_\_\_\_\_

Inspection Date: Nov 15, 2025 Date of Previous Inspection: Unk.

Reason for Inspection: Annual Scheduled  
After Flood  
Other (Please Specify) \_\_\_\_\_

GPS Photos Taken: N Photos Downloaded: Y  
Saved In: HEI Bismarck Server H:\JBN\6000\6025\6025\_0006 Fox Island O&M

Previous, Most Recent Flood Crest: 11.16 ft (at Bismarck Gage) January 23, 2025

Did levee system function properly during high water? Y

Issues to be addressed, if any: None known

Reviewed Last Inspection Report: N

Maintenance work completed since last inspection: None known

Were Previously Recommended Corrective Measures Completed: N/A

If so, describe action taken: \_\_\_\_\_

Date of Last Top of Levee Survey: Unknown

\*If its been 5 years or more since last survey, schedule one to be completed

Original Designed Top of Levee Elevation: 1636.84 to 1637.58

If survey was completed under this inspection, please note any deficiencies in original design elevation (by station). Attach copy of survey with this inspection form.



**Condition of Levee**

\*Specify the approximate locations and take pictures of all issues

Vegetation: 100 % Cover

Cracks: None noted

-----  
-----  
-----  
-----

Width, Depth & Length of Cracks

Slides or Slumping None Noted

Issues:

-----  
-----

Erosion Issues: None noted

-----  
-----

Clear Zone None noted  
Encroachments:

-----  
-----

Detail what the Encroachment is

Retaining Wall Good  
Condition:

-----  
-----  
-----

Flood Wall Condition: Good

-----  
-----  
-----

Possible issues to watch are:  
random cracking, caulk condition,  
staining

Pump Station & Good  
Gate Wells: Sediment noted in ST MH #1 and culvert pipe

-----  
-----

Complete inspections with Hwy  
Department Staff. Review Hwy  
Department notes on maintenance  
activities since last inspection

Rodent Issues: None noted

-----  
-----

Riprap Condition: Good

-----  
-----

**Corrective Measures Recommended:**

Recommend sediment removal in ST MH #1 and culvert.

Recommend mowing of levee on Boise-Tavis property, located on Sheets PP-17 to PP-19 or approx. Sta 100+00 to 111+00 as recommended in Section 2.2 of Fox Island O&M Manual. Mowing will deter rodent burrowing and facilitate monitoring and inspection.

Date Corrective Measures were taken care of: \_\_\_\_\_  
Project Numbers of Repair Projects, (if applicable): \_\_\_\_\_

**Items to be monitored:**

Noted installation of valve vault on existing 42 inch sanitary sewer line located at approximately Station 100+57. Recommend monitoring for settlement and for establishment of turf cover from new seeding of disturbed area.

*Provide Copy of Report to Superintendent for O&M records*



Note sediment in ST MH #1 culvert located at Station 18+28.





Note Sediment inside ST MH #1 located at Station 18+28





Note new valve vault on City 42 inch sanitary sewer line.





Note tall grass on Boise Tavis property at Station 100+00 to 111+00







# Missouri River Correctional Center Flood Control Project

## Flood Risk Reduction Annual Levee Inspection Report

Levee Name/Location: Missouri River Correctional Center Flood Control Project

Original Construction Project No. 6025-0012 Inspector(s) Travis Johnson

Superintendent: N/A

Inspection Date: 11-15-2025

Date of Previous Inspection: 9/6/2024

Reason for Inspection: Annual Scheduled  
After Flood  
Other (Please Specify) \_\_\_\_\_

GPS Photos Taken: N Photos Downloaded: Y  
Saved In: Bismarck HEI Server H:\JBN\6000\6025\6025 0012 MRCC O&M

Previous, Most Recent Flood Crest: 11.16 ft (at Bismarck Gage) January 23, 2025

Did levee system function properly during high water? Y

Issues to be addressed, if any: \_\_\_\_\_  
\_\_\_\_\_

Reviewed Last Inspection Report: Y

Maintenance work completed since last inspection: None known  
\_\_\_\_\_  
\_\_\_\_\_  
\_\_\_\_\_

Were Previously Recommended Corrective Measures Completed: Unknown

If so, describe action taken: \_\_\_\_\_  
\_\_\_\_\_  
\_\_\_\_\_  
\_\_\_\_\_

Date of Last Top of Levee Survey: 2017

\*If its been 5 years or more since last survey, schedule one to be completed

Original Designed Top of Levee Elevation: 1635.70 to 1636.70

If survey was completed under this inspection, please note any deficiencies in original design elevation (by station). Attach copy of survey with this inspection form.

\_\_\_\_\_  
\_\_\_\_\_

**Condition of Levee**

\*Specify the approximate locations and take pictures of all issues

Vegetation: 100 % Cover

Cracks: None noted

-----  
-----  
-----  
-----

Width, Depth & Length of Cracks

Slides or Slumping None noted

Issues: -----  
-----

Erosion Issues: No erosion noted

Minor vehicle rutting on levee

-----  
-----

Clear Zone Previously authorized fence posts. No new items.  
Encroachments: -----

Detail what the Encroachment is

-----  
-----

Retaining Wall N/A

Condition: -----  
-----

Flood Wall Condition: N/A

-----  
-----  
-----

Possible issues to watch are:  
random cracking, caulk condition,  
staining

Pump Station & Noted damaged hatch cover on gateway at Station  
Gate Wells: 49+30 near MRCC entrance.

Complete inspections with Hwy  
Department Staff. Review Hwy  
Department notes on maintenance  
activities since last inspection

-----  
-----

Rodent Issues: None noted

-----  
-----

Riprap Condition: Good

-----  
-----



**Corrective Measures Recommended:**

Monitor levee for rutting. Avoid traveling on levee top and use trail adjacent.

Possible maintenance at hatch on gatewell at Station 49+30. Increase protection measures to avoid being struck by snow removal equipment or vehicles.

Noted tall grass on portion of the levee. Recommend at least annual mowing per Section 2.2 of the MRCC O&M Manual.

Date Corrective Measures were taken care of: \_\_\_\_\_

Project Numbers of Repair Projects, (if applicable): \_\_\_\_\_

**Items to be monitored:**

Was informed that MRCC would be constructing walking path/driving trail adjacent to levee at approx. Station 19+00 to 29+50.

Notified Warden that plans for construction of trail that may impact levee and toe drain should be submitted to BCWRD for review.

*Provide Copy of Report to Superintendent for O&M records*

Noted damaged hatch cover at Station 49+30

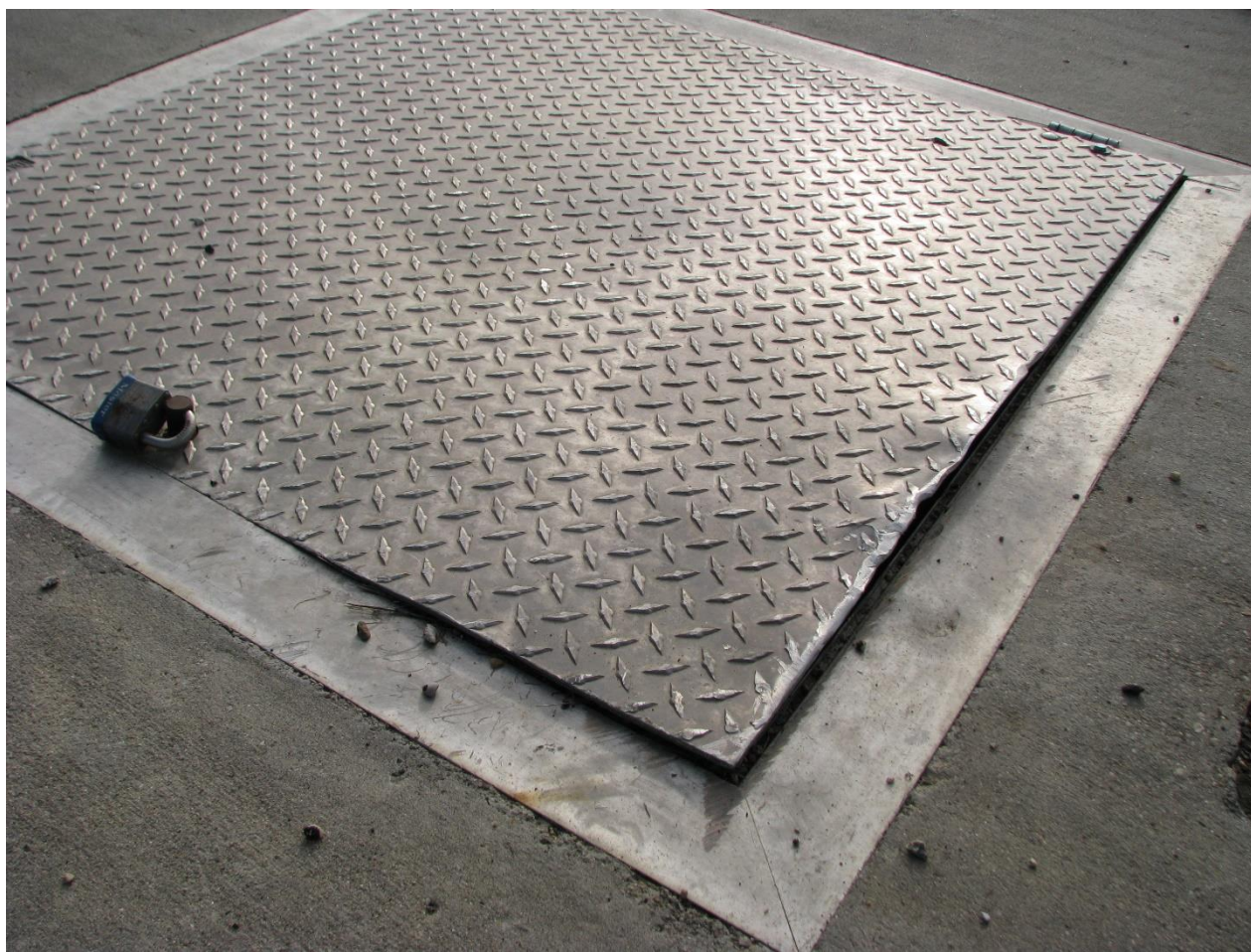



Noted minor vehicle rutting on top of levee.





Tall vegetation noted. Recommended at least annual mowing to aid in inspection and monitoring, and to deter rodent activity.





## December 2025 Bills

Name	Project	Invoice	Amount
Bismarck Parks & Rec	November, 2025 + Roof Repairs and Playground	6259	\$ 202,205.59
Bliss Law Firm	General Legal	664	\$ 2,738.00
Bliss Law Firm	McDowell Dam Leases	664	\$ 2,117.20
Fronteer Professional Services	October 2025 Presort Charges	5235	\$ 64.55
Fronteer Professional Services	November Admin Work and Terminal Server	5282	\$ 2,340.00
Low Key Services, LLC	Burnt Creek Levee Inspection	10007	\$ 240.00
Low Key Services, LLC	Fox Island Levee Inspection	10008	\$ 420.00
Low Key Services, LLC	MRCC Levee Inspection	10009	\$ 420.00
Office of the State Auditor	2024 Audit	SA0000020247	\$ 8,089.61
Pro Forms	Checks	167579	\$ 173.27
		Total Bills	\$ 218,808.22



**BISMARCK PARKS AND  
RECREATION DISTRICT**  
Est. 1927

400 E Front Ave  
Bismarck, ND 58504-5641  
Phone: 701.222.6455

**INVOICE**

**BILLED TO:**  
Burleigh County Water Resource District  
Wendy Egli  
PO Box 1255  
Bismarck, ND 58502-1255

DATE: 12/3/2025  
INVOICE #: 06259  
DUE DATE: 12/31/2025  
TOTAL DUE: 202,205.59

CUSTOMER ACCOUNT # : 1017

ITEM DESCRIPTION	UNITS	PRICE	AMOUNT
McDowell Dam November 2025	1.00	202,205.59	202,205.59
<b>TOTAL THIS INVOICE</b>			202,205.59

Please include account number with your payment.

For questions, contact Julie Fornshell 701.222.6455

**REMIT TO:**

Bismarck Parks and Recreation District  
400 E Front Ave  
Bismarck ND 58504-5641

Please remit bottom portion of invoice with your payment.  
Thank you!

CUSTOMER ACCOUNT # : 1017  
DATE: 12/3/2025  
INVOICE #: 06259  
DUE DATE: 12/31/2025  
TOTAL DUE: 202,205.59

**BURLEIGH COUNTY WATER RESOURCE DISTRICT  
McDowell Dam Monthly Billing**

**Bismarck Parks & Recreation District  
400 E. Front Ave  
Bismarck, ND 58504**

**For The Month Ended November 30, 2025**

**Date Submitted: 12/3/2025**

---

Salaries & Wages	\$ 6,272.05
Employer Payroll Taxes	479.81
Employee Pension & Health/Life/ Diability Benefits	2,584.75
Property & Liability Insurance	-
Operating Expenses	6,446.57
Capital Improvement Expenses	<u>173,787.25</u>
Total Expenses	<u>\$ 189,570.43</u>
Administrative Fee	
(25% of Operating Expenses)	\$ 3,945.80
(5% of Capital Improvement Expenses)	<u>8,689.36</u>
Total Amount Requested	<u><u>\$ 202,205.59</u></u>

*K. Furst*

Prepared By

Board Member

*Finance Director*

Title

# McDowell Dam Monthly Billing

November-25

## Salaries & Wages

Salaries - Full time	\$ 4,749.98	
Sick Leave Overage	-	
Wages - Part time	1,522.07	
Wages - Part time (Overtime)	-	
Total Salaries & Wages		\$ 6,272.05

## Employer Payroll Taxes

Social Security/Medicare	479.81	
Unemployment- ND Job Service	-	
Total Employer Payroll Taxes		479.81

## Employee Benefits

Pension	494.00	
Health, Life, & Disability Insurance	2,090.75	
Total Employee Benefits		2,584.75

## Property & Liability Insurance

General Liability	-	
Multi Coverage	-	
Auto Liability	-	
Total Property & Liability Insurance		-

## Operating Expenses

Professional Services	-	
Service Contracts	-	
Sanitary Systems	-	
Parking Lots & Trail Repair	-	
Shop Supplies	-	
Janitorial Supplies	-	
Miscellaneous Supplies	11.99	
Fuel	1,635.81	
Repairs & Replacement	3,903.16	
Uniforms	-	
Concession Purchases	-	
Tools & Small Equipment less \$500	29.98	
Equipment over \$500	-	
Misc. Charges, Permits, and Licenses	-	

## Expenses Incurred - NOT Previously Billed

Oct 25 - Credit Card Fees	7.50	
	5,588.44	

## Utilities

Natural Gas	-	
Electricity	577.02	
Garbage Removal	-	
Water	108.29	
Telephone	172.82	
Total Utilities	858.13	
Total Operating Expenses		6,446.57

## Capital Improvements

Building and Building Remodeling	44,129.25	
Capital Equipment	-	
Capital Outlay	129,658.00	
Total Capital Improvements		173,787.25
Total Expenses		\$ 189,570.43





Bismarck Parks and Recreation District

# Detail Report Account Detail

Date Range: 11/01/2025 - 11/30/2025

Account		Name				Beginning Balance	Total Activity	Ending Balance
Fund: 01 - GENERAL FUND								
<u>01.12.000.510100</u>		FULL-TIME SALARIES				51,774.78	4,749.98	56,524.76
Post Date	Packet Number	Source Transaction	Pmt Number	Description	Vendor		Amount	Running Balance
11/14/2025	PYPKT01657	PYPKT01657 - 2025-11		ROBINSON, DAVID H.:000415 - McDow			2,374.99	54,149.77
11/26/2025	PYPKT01662	PYPKT01662 - 2025-11		ROBINSON, DAVID H.:000415 - McDow			2,374.99	56,524.76
<u>01.12.000.510200</u>		PART-TIME SALARIES				38,299.80	1,522.07	39,821.87
Post Date	Packet Number	Source Transaction	Pmt Number	Description	Vendor		Amount	Running Balance
11/14/2025	PYPKT01658	PYPKT01658 - 2025-11		JOHNSON, SETH M.:000217 - Operation			754.38	39,054.18
11/26/2025	PYPKT01663	PYPKT01663 - 2025-11		JOHNSON, SETH M.:000217 - Operation			767.69	39,821.87
<u>01.12.000.530140</u>		MISCELLANEOUS SUPPLIES				2,139.67	11.99	2,151.66
Post Date	Packet Number	Source Transaction	Pmt Number	Description	Vendor		Amount	Running Balance
11/10/2025	APPKT04186	1872796	DFT0001656	RODENT CONTROL	0948 - US BANK - ONE CARD		11.99	2,151.66
Purchased From Vendor: 0352 - FARM & HOME SUPPLY, INC.								
<u>01.12.000.531300</u>		FUEL				2,144.65	1,635.81	3,780.46
Post Date	Packet Number	Source Transaction	Pmt Number	Description	Vendor		Amount	Running Balance
11/06/2025	APPKT04160	8162	220317	FUEL 229.00 GAL 10/22/25 - MCD	0918 - TRI-ENERGY COOPERATIVE		677.84	2,822.49
11/20/2025	APPKT04176	2153	220417	DIESEL FUEL 230.2 GAL - MCD	0918 - TRI-ENERGY COOPERATIVE		786.83	3,609.32
11/20/2025	APPKT04176	FLTS-2025-00000020	220384	OCTOBER 25 FUEL USAGE - MCD	0209 - CITY OF BISMARCK		171.14	3,780.46

**Detail Report**

**Date Range: 11/01/2025 - 11/30/2025**

Account		Name				Beginning Balance	Total Activity	Ending Balance
<u>01.12.000.531400</u>		REPAIRS & REPLACEMENT				24,793.88	3,903.16	28,697.04
Post Date	Packet Number	Source Transaction	Pmt Number	Description	Vendor		Amount	Running Balance
11/05/2025	APPKT04157	ADA GRILLS	220267	ACCESSIBLE GRILL (1) - MCD	2547 - GRONDAHL RECREATION, INC.		379.34	25,173.22
11/06/2025	APPKT04160	09-237184	220303	TIRES (2), CALCIUM CHLORIDE - BOBCA	0676 - OK TIRE STORE - BISMARCK CC		1,435.26	26,608.48
11/06/2025	APPKT04160	09-237186	220303	TIRE DISPOSAL FEE (2)	0676 - OK TIRE STORE - BISMARCK CC		100.00	26,708.48
11/06/2025	APPKT04160	3946	220288	HAND DRYER REPL (BTHRM), EXTERIOR	5426 - GROSS, MATTHEW		180.00	26,888.48
11/06/2025	APPKT04160	63859	220277	GRASS SEED (XC)	0206 - CHESAK SEED HOUSE		550.00	27,438.48
11/10/2025	APPKT04186	1536-13492	DFT0001656	LED CAPSULE, STOP LEAK	0948 - US BANK - ONE CARD		116.76	27,555.24
Purchased From Vendor: 0682 - O'REILLY AUTO PARTS								
11/10/2025	APPKT04186	2000139-83538185	DFT0001656	ENGINE HEATING PAD	0948 - US BANK - ONE CARD		20.09	27,575.33
Purchased From Vendor: 0964 - WALMART COMMUNITY BRC								
11/10/2025	APPKT04186	21947 01 4657	DFT0001656	OUTLET COVERS	0948 - US BANK - ONE CARD		43.12	27,618.45
Purchased From Vendor: 0581 - MENARDS INC								
11/10/2025	APPKT04186	7079196	DFT0001656	PROPANE TANK, DRILL BIT SET, PUNCH	0948 - US BANK - ONE CARD		62.97	27,681.42
Purchased From Vendor: 0785 - RUNNINGS SUPPLY INC								
11/10/2025	APPKT04186	99283 02 9071	DFT0001656	CAULK, FASCIA - MCD SHOWER HOUSE	0948 - US BANK - ONE CARD		26.26	27,707.68
Purchased From Vendor: 0581 - MENARDS INC								
11/10/2025	APPKT04186	99327 08 2437	DFT0001656	MOTION LIGHT, PUNCH SET, STAIN, SOF	0948 - US BANK - ONE CARD		257.35	27,965.03
Purchased From Vendor: 0581 - MENARDS INC								
11/20/2025	APPKT04176	1536-137834	220407	WIPER BLADES, TOGGLE SWITCH, 5QT	0682 - O'REILLY AUTO PARTS		119.97	28,085.00
11/20/2025	APPKT04176	1536-137838	220407	FILTERS FOR LAWN MOWER, TRACTOR -	0682 - O'REILLY AUTO PARTS		301.79	28,386.79
11/20/2025	APPKT04176	167093-35239	220405	CEMENT GARBAGE CANS (MCD BATHR	0668 - NORTH DAKOTA SURPLUS PROPERTY		200.00	28,586.79
11/20/2025	APPKT04176	81319	220385	ANNUAL FIRE EXTINGUISHER INSPECTI	0260 - DAKOTA FIRE STATION, INC.		110.25	28,697.04
<u>01.12.000.531700</u>		TOOLS & SMALL EQUIP LESS \$500				1,742.51	29.98	1,772.49
Post Date	Packet Number	Source Transaction	Pmt Number	Description	Vendor		Amount	Running Balance
11/20/2025	APPKT04176	7099541	220414	PLIERS LONG NOSE LOCKING - MCD	0785 - RUNNINGS SUPPLY INC		29.98	1,772.49
<u>01.12.000.540130</u>		ELECTRICITY				6,066.88	577.02	6,643.90
Post Date	Packet Number	Source Transaction	Pmt Number	Description	Vendor		Amount	Running Balance
11/24/2025	APPKT04181	OCTOBER 25	220421	OCTOBER 25 (SVC 10/1/25 - 11/1/25)	0175 - CAPITAL ELECTRIC COOPERATIVE		577.02	6,643.90
<u>01.12.000.540150</u>		WATER				2,008.35	108.29	2,116.64
Post Date	Packet Number	Source Transaction	Pmt Number	Description	Vendor		Amount	Running Balance
11/28/2025	APPKT04191	NOVEMBER 25 BILLIN		NOVEMBER 25 BILLING	0837 - SOUTH CENTRAL REGIONAL WATER		108.29	2,116.64
<u>01.12.000.540160</u>		TELEPHONE				1,756.58	172.82	1,929.40
Post Date	Packet Number	Source Transaction	Pmt Number	Description	Vendor		Amount	Running Balance
11/10/2025	APPKT04186	103125MCD	DFT0001656	OCT25 PHONE/INTERNET CHARGES MC	0948 - US BANK - ONE CARD		172.82	1,929.40
Purchased From Vendor: 0087 - BEK COMMUNICATIONS								

**Detail Report**

**Date Range: 11/01/2025 - 11/30/2025**

Account						Beginning Balance	Total Activity	Ending Balance
<u>01.12.000.550100</u>						20,907.50	2,090.75	22,998.25
HEALTH INSURANCE							Amount	Running Balance
Post Date	Packet Number	Source Transaction	Pmt Number	Description	Vendor			
11/28/2025	APPKT04191	EINS-2025-00000011		NOVEMBER 25 HEALTH BENEFITS	0209 - CITY OF BISMARCK		2,090.75	22,998.25
<u>01.12.000.570100</u>						14,078.54	44,129.25	58,207.79
BUILDING & BUILDING REMODELING							Amount	Running Balance
Post Date	Packet Number	Source Transaction	Pmt Number	Description	Vendor			
11/19/2025	APPKT04173	25-5843-1	220329	REMOVE & REPL METAL ROOFING BLDG	6036 - BETTER ROOFING AND CONTRACTING, LLC		44,129.25	58,207.79
<u>01.12.000.570800</u>						6,350.76	129,658.00	136,008.76
CAPITAL OUTLAY							Amount	Running Balance
Post Date	Packet Number	Source Transaction	Pmt Number	Description	Vendor			
11/05/2025	APPKT04157	PMT #1 MCD PLAYGR	220269	MCDOWELL DAM PLAYGROUND PMT #	6818 - PARAMOUNT BUILDERS		129,658.00	136,008.76
Total Fund: 01 - GENERAL FUND:						Beginning Balance: 172,063.90	Total Activity: 188,589.12	Ending Balance: 360,653.02
Grand Totals:						Beginning Balance: 172,063.90	Total Activity: 188,589.12	Ending Balance: 360,653.02

# FARM & HOME SUPPLY, INC.

1406 E. Main Ave. - Box 873  
Bismarck, North Dakota 58502-0873  
Phone (701) 258-3436  
Locally Owned

Customer's Order No.		Date		9/29 20 25	
Name <i>Parkes + Pac Bismarck</i>					
Address <i>Dave Robinson</i>					
2/29					
SOLD BY <i>BK</i>	CASH <i>VISA</i>	C.O.D.	CHARGE	ON ACCT.	MOSE. RETD. PAID OUT
QUAN.	DESCRIPTION			PRICE	AMOUNT
1	<i>Pro 200p</i>				11.99
	<i>gopher + mole killer</i>				

<p>FARM HOME SPLY INC 1406 E. MAIN BISMARCK, ND 585010000</p> <p>09/29/2025 15:14:23</p> <p>CREDIT CARD VISA SALE</p> <p>Card #: XXXXXXXXXXXX6485 Chip Card: VISA CREDIT AID: A0000000031010 SEQ #: 27 Batch #: 760 INVOICE 27 Approval Code: 066005 Entry Method: Chip Read Mode: Issuer Tax Amount: \$0.00 Cust Code:</p>	<p>SALE AMOUNT \$11.99</p> <p>CUSTOMER COPY</p>	
---	---	--

All claims and returned goods MUST be accompanied by this bill.		TAX	
1872796	Received By	TOTAL	11.99

PROFORMS • 701-222-1212

B-9

COPY

**PURCHASE ORDER**  
**BISMARCK PARKS AND RECREATION DISTRICT**  
400 East Front Avenue • Bismarck, ND 58504  
Phone: (701) 222-6455 • Fax (701) 221-6838

No. 105601

ND Tax Exempt Number: E-4674  
Federal ID Number: 45-0409352

Name

*Tri Energy*

Vendor

*918*

Address

Date

*10/24/25*

Notes

*Fuel*

		Project Number	Cost
Acct #	<i>01.12.000.531300</i>		<i>\$677.84</i>
Description	<i>Gasoline</i>		
Acct #			
Description			
Acct #			
Description			
Acct #			
Description			
Acct #			
Description			
Acct #			
Description			
Acct #			
Description			
Acct #			
Description			
Total			<i>677.84</i>

Employee's Signature

*[Signature]*

Manager's Signature

*[Signature] DM*

Approved By

*[Signature]*

ORIGINAL



219 N. 20TH STREET  
BISMARCK, ND 58501  
701-223-8707

All Gasoline is Detergent Additized

UN-DYED

THE PRICE OF THIS DIESEL FUEL:

☐ DOES ☐ DOES NOT

INCLUDE FEDERAL MOTOR FUEL TAXES

AND DOES NOT CONTAIN VISIBLE

EVIDENCE OF DYE.

DYED

THIS PRODUCT IS DYED DIESEL FUEL

NON-TAXABLE USE ONLY. PENALTY FOR

TAXABLE USE IF THIS BOX ☐ MARKED.

OFF HIGHWAY/NOT LEGAL FOR MOTOR

VEHICLE USE.

Date: 10/22/2025

166430 INVOICE: 8162

BISMARCK CITY/PARKS&RECREATION

400 E FRONT AVE

BISMARCK, ND 58504

Delivery Address

1951 93RD ST NE

BISMARCK ND

SALESMAN:001 Truck:610

Charge SN: 608-CITY-OWN

Tank: 007 TANK SIZE(Gal): 300

START %: 0 FILLED TO %: 0

DESC QTY PRICE TOTAL

91 PREMIUM - FED TAX EXPT

229.000 2.7300 625.17

ND GAS TAX

229.000 0.23000 52.67

SALES TAX : 8.00

TOTAL COST : 677.84







219 N. 20TH STREET  
BISMARCK, ND 58501  
701-223-8707

All Gasoline is Detergent Additized

UN-DYED

THE PRICE OF THIS DIESEL FUEL:  
☐ DOES ☐ DOES NOT  
INCLUDE FEDERAL MOTOR FUEL TAXES  
AND DOES NOT CONTAIN VISIBLE  
EVIDENCE OF DYE.

DYED

THIS PRODUCT IS DYED DIESEL FUEL.  
NON-TAXABLE USE ONLY. PENALTY FOR  
TAXABLE USE IF THIS BOX IS MARKED,  
OFF HIGHWAY/NOT LEGAL FOR MOTOR  
VEHICLE USE.

SALE # 2153 DATE 11/03/23 11:30:06  
COUNT: START 0.0 END 230.2  
GROSS DELIVERY 230.2 GALLONS  
DIESEL DISTILLATE

166430 INVOICE: 2153  
BISMARCK CITY/PARKS&RECREATION  
400 E FRONT AVE  
BISMARCK, ND 58504

Delivery Address  
1951 93RD ST NE

BISMARCK ND

SALESMAN:001 Truck:610

Charge SH: DIES-NCD-DWN

Tank: 014 TANK SIZE(Gal): 560

START %: 0 FILLED TO %: 0

DESC QTY PRICE TOTAL

#1 FIELDMASTER

230.200 3.3780 777.62

ND EX TAX FUEL

230.200 0.04000 9.21

SALES TAX : 0.00

TOTAL COST : 786.83



**PURCHASE ORDER**  
**BISMARCK PARKS AND RECREATION DISTRICT**  
400 East Front Avenue • Bismarck, ND 58504  
Phone: (701) 222-6455 • Fax (701) 221-6838

No. 100729

ND Tax Exempt Number: E-4674  
Federal ID Number: 45-0409352

Name City of Bismarck

Vendor 209

Address \_\_\_\_\_  
\_\_\_\_\_  
\_\_\_\_\_

Date 11-12-25

Notes \_\_\_\_\_  
Fuel usage Oct 2025  
\_\_\_\_\_

Acct #	Project Number	Cost
01.04.000.531300		
Description <u>Park ops</u>		3,551.12
Acct # 01.15.000.531300		
Description <u>Sibley</u>		389.20
Acct # 01.12.000.531300		
Description <u>McDowell Dam</u>		171.14
Acct # 01.19.000.531300		
Description <u>Burleigh County</u>		146.44
Acct # 01.30.000.531300		
Description <u>AWC</u>		56.41
Acct #		
Description		
Acct #		
Description		
Acct #		
Description		
Total		4,314.31

Employee's Signature 

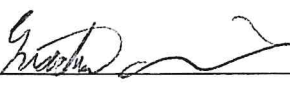
Manager's Signature  DM

  
Approved By

ORIGINAL



City of Bismarck  
PO Box 5503  
Bismarck, ND 58506  
(701) 355-1615

PARKS & RECREATION  
400 E FRONT AVE  
BISMARCK, ND 58504-5641

## INVOICE

DATE: 11/05/2025  
DUE DATE: 12/05/2025  
CUSTOMER NO: 509  
INVOICE NO: FLTS-2025-00000020  
DEPARTMENT: 660 Public Works Service  
Operations

Billing Inquiries:  
Public Works  
(701)355-1700

Description	Quantity	Unit Price	Total Price
Sale of Fuel-Hwys/Streets	1	\$488.8800	\$488.88
Sale of Unleaded Fuel-Hwy/St	1	\$3,825.4300	\$3,825.43

Invoice Total: \$4,314.31  
Prepaid Amount: -\$0.00  
**Balance Due: \$4,314.31**

Park ops      Sibley      McD      AWC      County      = 4314.31  
3,551.12      389.20      171.14      56.41      146.44

----- tear here -----

# City of Bismarck

## Simple Invoice By Account For Driver

Date Range From : 10/01/2025 12:00:00AM To : 10/31/2025 11:59:00PM

Driver	Driver Name	# of Trans	Price	Total Quantity	Total Amount
<b>Account :</b> 1099	PARKS & REC				
<b>Product :</b> 01	Unleaded				
2522000000001464	PARKS/ DAN S.	2	\$2.440	61.900	\$149.75
2522000000002179	PARKS/ LYNN M.	3	\$2.440	65.300	\$157.57
2522000000002202	PARKS // DAVE MAYER	2	\$2.400	41.150	\$98.44
2522000000002720	PARKS /// ADAM KELLER	3	\$2.440	75.550	\$182.31
2522000000002722	PARKS /// MERKEL RILEY	4	\$2.440	97.450	\$234.85
2522000000002723	PARKS // JOSH BECKER	2	\$2.440	45.790	\$110.14
2522000000003072	PARKS // TROY FINK	4	\$2.440	92.190	\$222.94
2522000000003157	PARKS / MARTHA	1	\$2.440	26.660	\$65.05
2522000000003278	PARKS//MILLER, RYAN	5	\$2.440	105.110	\$252.69
2522000000003414	PARKS / JEFF OSTER	2	\$2.440	54.050	\$131.88
2522000000003425	PARKS / JOEY LAFAVE	2	\$2.440	52.820	\$127.88
2522000000003427	PARKS /// PAT GILHOOLY	1	\$2.400	14.000	\$33.60
2522000000003597	PARKS /// SHOP	3	\$2.440	47.260	\$114.85
2522000000003598	PARKS /// SHOP	1	\$2.440	28.000	\$68.32
2522000000003604	PARKS /// ROBINSON	3	\$2.440	70.910	\$171.14
2522000000003760	PARKS //// STEVE G	3	\$2.440	60.660	\$146.44
2522000000003827	PARKS / BOSCH JAMIE	4	\$2.440	77.350	\$187.20
2522000000003836	PARKS / MATZKE, BRAD	5	\$2.440	109.840	\$264.75
2522000000003903	PARKS / AQUATIC CENTER	1	\$2.380	23.700	\$56.41
2522000000003920	PARKS/ CAPITAL RACQUET	1	\$2.440	22.000	\$53.68
2522000000003931	PARKS / CORY LANG	2	\$2.440	38.440	\$92.38
2522000000003954	Parks/Rich H	3	\$2.440	78.480	\$189.35
2522000000003955	PARKS/BALES, COLIN	1	\$2.400	29.240	\$70.18
2522000000004126	PARKS/MIKE SULLIVAN	2	\$2.440	46.200	\$111.94
2522000000004145	Emmy Videen Parks Rec	1	\$2.440	50.280	\$122.68
2522000000004185	PARKS ///// HAADEM ,JERAD	4	\$2.440	91.600	\$221.70
2522000000004199	PARKS /// JACE CARROLL	3	\$2.440	77.810	\$187.31
<b>Totals for Product :</b>				<b>1583.740</b>	<b>\$3,825.43</b>
<b>Product :</b> 02	Clear Diesel				
2522000000003760	PARKS //// STEVE G	2	\$3.030	29.631	\$89.79
2522000000004145	Emmy Videen Parks Rec	1	\$3.030	66.492	\$201.47
<b>Totals for Product :</b>				<b>96.123</b>	<b>\$291.26</b>
<b>Product :</b> 03	Dyed Diesel				
2522000000003827	PARKS / BOSCH JAMIE	1	\$3.030	6.646	\$20.14
2522000000004199	PARKS /// JACE CARROLL	2	\$3.030	58.574	\$177.48
<b>Totals for Product :</b>				<b>65.220</b>	<b>\$197.62</b>
<b>Totals for Account :</b>				<b>1745.083</b>	<b>\$4,314.31</b>



**PURCHASE ORDER**  
**BISMARCK PARKS AND RECREATION DISTRICT**  
 400 East Front Avenue • Bismarck, ND 58504  
 Phone: (701) 222-6455 • Fax (701) 221-6838

No. 100717

ND Tax Exempt Number: E-4674  
 Federal ID Number: 45-0409352

Name Grondahl Recreation

Vendor 2547

Address \_\_\_\_\_

Date 10-31-25

Notes

Accessible Grills

Acct #	Project Number	Cost
30.00.000.571250 <sup>100</sup>	25.033	
Description <u>Park Operations (4)</u>		1,517.33
30.00.000.571250 <sup>100</sup>	25.033	
Description <u>General Sibley (1)</u>		379.33
01.12.000.531400		
Description <u>McDowell Dam (1)</u>		379.34
Acct #		
Description		
Acct #		
Description		
Acct #		
Description		
Acct #		
Description		
Acct #		
Description		
Total		2,276.00

Employee's Signature \_\_\_\_\_

Manager's Signature [Signature] DM

[Signature]  
 Approved By

ORIGINAL





# INVOICE

# \_\_\_\_\_

Date \_\_\_\_\_

Bill To	Ship To
Customer <u>BISMARCK PARK DISTRICT</u>	Recipient <u>BISMARCK PARKS SHOP</u>
Address <u>400 EAST FRONT AVE</u>	Address _____
<u>BISMARCK, ND 58504</u>	_____
<u>ATTN: DAVE MAYER</u>	_____
Phone # _____	Phone # _____
Payment Due <u>11/15/25</u>	Delivery Date <u>ASAP</u>
Payment Terms <u>AS NOTED</u>	Shipping Method <u>BEST WAY</u>
	Shipping Terms <u>PREPAID</u>

QTY.		PRICE	LINE TOTAL
6	ADA GRILLS WITH SWIVEL SHELF-SURFACE MT		\$2,276.00
	FREIGHT		INCLUDED

Thank you for your business!  
Larry Grondahl  
Grondahl Recreation Inc.  
1202 18th St. West, Williston, ND 58801  
Office 701-572-7897 Cell 701-572-0824  
Fax 701-770-7897  
Email grondahl@dia.net

Sub Total	
Sales Tax	
Invoice Total	\$2,276.00



# INVOICE

Invoice Date	Cust No.	Order No	Page	Invoice No.
10/30/2025	20201	09 - 271554	1 / 1	09 - 237184
License:		Mileage: 0	Time in 3:57 PM	
COPY				

O.K. Tire Store-Bism Com  
3935 Miriam Avenue  
Bismarck, ND 58501  
Phone: (701) 255-0822

**Sold To:** BISMARCK PARK & RECREATIO  
400 E FRONT AVE  
BISMARCK, ND 58504-5641

**Ship To:** BISMARCK PARK & RECREATIO  
400 E FRONT AVE  
BISMARCK, ND 58504-5641

Purchase Ord. No.	Sales Person	Main Phone	Other Phone	Ship Via	Terms: Net 10th Entered: SS Finalized: SS		
MCDOWELL	040	(701) 222-6455					
Item No.	Description	Qty Ordered	Qty Shipped	F.E.T.	Price	Net Extension	
94003006	14.9-24 BKT IRRIG TR117 R1 6P TT	2	2		314.88	629.76	
39226	14.9/400/420R24 MICH TUBE	2	2		110.25	220.50	
TS33	SERVICE CALL - CHANGE & MOUNT (WET)	2	2		135.00	270.00	
SUPT	SHOP SUPPLIES	1	1		15.00	15.00	
TS20	CALCIUM CHLORIDE - PER GAL	100	100		3.00	300.00	
	*MCDOWELL DAM BOBCAT TRACTOR						
	*DAVID ROBINSON						

Lug nuts must be re-torqued within 50 to 100 miles of initial tightening.

Tires should be rotated every 5,000 to 6,000 miles.

All returned product is subject to inspection prior to credit being issued. Any product returned after 30 days from invoice date is subject to a 15% restocking fee. Discontinued or special order product is not eligible for return.

**Sub-Total Parts:** 1,165.26  
**Sub-Total Labor:** 270.00  
**Non-Taxable Amount:** 1,435.26  
**Taxable Amount:** 0.00  
**Total:** 1,435.26

X

Customer Authorization for Total

COPY

**ALL CREDIT CARD PAYMENTS WILL RECEIVE A 3% SURCHARGE IN ADDITION TO THE INVOICE AMOUNT**



O.K. Tire Store-Bism Com  
3935 Miriam Avenue  
Bismarck, ND 58501  
Phone: (701) 255-0822

10/30/2023	20201	09 - 211301	1 / 1	09 - 231100
License:	Mileage: 0	Time in 4:42 PM		
COPY				

Sold To: BISMARCK PARK & RECREATIO  
400 E FRONT AVE  
BISMARCK, ND 58504-5641

Ship To: BISMARCK PARK & RECREATIO  
400 E FRONT AVE  
BISMARCK, ND 58504-5641

Purchase Ord. No.	Sales Person	Main Phone	Other Phone	Ship Via	Terms: Net 10th Entered: SS Finalized: SS			
MCDOWELL	040	(701) 222-6455						
Item No.	Description			Qty Ordered	Qty Shipped	F.E.T.	Price	Net Extension
JKT	SCRAP TRUCK TIRE DISPOSAL CHARGE *THREW TIRES *PER DAVID ROBINSON INVOICE 271554			2	2		50.00	100.00

Lug nuts must be re-torqued within 50 to 100 miles of initial tightening.

Tires should be rotated every 5,000 to 6,000 miles.

All returned product is subject to inspection prior to credit being issued. Any product returned after 30 days from invoice date is subject to a 15% restocking fee. Discontinued or special order product is not eligible for return.

Sub-Total Parts: 100.00  
Non-Taxable Amount: 100.00  
Taxable Amount: 0.00  
Total: 100.00

X

Customer Authorization for Total

COPY

ALL CREDIT CARD PAYMENTS WILL RECEIVE A 3% SURCHARGE IN ADDITION TO THE INVOICE AMOUNT



**PURCHASE ORDER**  
**BISMARCK PARKS AND RECREATION DISTRICT**  
400 East Front Avenue • Bismarck, ND 58504  
Phone: (701) 222-6455 • Fax (701) 221-6838

No. 105603

ND Tax Exempt Number: E-4674  
Federal ID Number: 45-0409352

Name Gross Electric

Vendor 5426

Address \_\_\_\_\_

Date 10/31/25

Notes Replace hand dryer womens bathroom and  
locate access to exterior lights

		Project Number	Cost
Acct #	01.12.000.531400		\$180.00
Description	Electrical work main Shower house		
Acct #			
Description			
Acct #			
Description			
Acct #			
Description			
Acct #			
Description			
Acct #			
Description			
Acct #			
Description			
Acct #			
Description			
Total			180.00

Employee's Signature [Signature]

Manager's Signature [Signature] dm

Approved By [Signature]

ORIGINAL



GROSS ELECTRIC, INC.  
1230 W Highland Acres Rd  
Bismarck, ND 58501  
7017514569

# Invoice

**BILL TO**

Bismarck Parks and Rec  
400 E Front Ave  
Bismarck, ND 58504

INVOICE #	DATE	TOTAL DUE	TERMS	ENCLOSED
3946	10/30/2025	\$180.00	Due on receipt	

QTY	DESCRIPTION	RATE	AMOUNT
	Work done @ Mcdowell dam- Install new hand dryer in mens bathroom, and check control for exterior lights at bathroom area.		
2	Labor Clint Sjomeling	90.00	180.00

Contact GROSS ELECTRIC, INC. to pay.

**BALANCE DUE**

**\$180.00**

Thank you for your business

**PURCHASE ORDER**  
**BISMARCK PARKS AND RECREATION DISTRICT**  
400 East Front Avenue • Bismarck, ND 58504  
Phone: (701) 222-6455 • Fax (701) 221-6838

No. 105602

ND Tax Exempt Number: E-4674  
Federal ID Number: 45-0409352

Name Chesak Seed house

Vendor 206

Address \_\_\_\_\_

Date 10/24/25

Notes Seed

		Project Number	Cost
Acct #	<u>01.12.000.531400</u>		
Description	<u>Grass seed for X-country track</u>		<u>550.00</u>
Acct #			
Description			
Acct #			
Description			
Acct #			
Description			
Acct #			
Description			
Acct #			
Description			
Acct #			
Description			
Acct #			
Description			
		Total	<u>550.00</u>

Employee's Signature

Manager's Signature

Approved By

ORIGINAL



**Chesak Seed House**  
 2320 E Thayer Ave  
 Bismarck, ND 58501  
 701-223-0391

# Invoice

Date	Invoice #
10/15/2025	63859

**Bill To**

**Ship To**

BISMARCK PARKS AND RECREATION  
 400 E FRONT AVE  
 BISMARCK, ND 58504

P.O. Number
MCDOWELL DAM

Bulk	PLS	Item	Description	Price Each	Amount
150		COUNTRY LAWN MIX	Blend with 50% Fairway Crested Wheat Grass, 30% Sheep Fescue, 20% Perennial Ryegrass. The Perennial Ryegrass establishes quickly, and is then replaced by the Fairway Crested and Sheep Fescue, perennial drought tolerant grasses. Recommended seeding rate of 5 pounds per 1,000 square feet. 1/4 inch seeding depth.	3.00	450.00
50		TOWN LAWN MIX	60% Kentucky Bluegrass, 10% Creeping Red Fescue, 30% Perennial Ryegrass for fast establishment that will later be displaced by the Kentucky Bluegrass. Able to establish in shady areas due to creeping red fescue. Makes a thick, lush lawn, but requires 1 to 1.5 inches of water per week. Recommended seeding rate of 5 pounds per 1,000 square feet. 1/4 inch seeding depth.	2.00	100.00

<b>Received By:</b>	<b>Date:</b>	<b>Total</b> \$550.00
All invoices past 30 days will be assessed a 1.75% monthly finance charge. All balances greater than 90 days must be paid in full to maintain Net 30 privileges. Accounts with balances reaching, or exceeding, this threshold must provide payment in full on any new purchases until past due balances are settled. Credit card payments greater than \$1,000.00 subject to 3% transaction fee. All returns based on inspection and assessed a 20% restocking fee. Returns valid up to 14 days from purchase date. No returns on custom mixes or open bags. Bulk orders not picked up or shipped within 3 weeks of invoice date will be canceled. Custom mixes not picked up or shipped within 3 weeks of invoice date will be shipped to the customer at their expense.		<b>Payments/Credits</b> \$0.00
		<b>Balance Due</b> \$550.00

**DEDICATED TO THE PROFESSIONAL**

Store 1536, 2201 E BISMARCK EXPY,  
BISMARCK, ND 58504 (701) 258-8755

Bill To:

**BISMARCK PARKS AND RECRE**

400 E FRONT AVE

BISMARCK, ND 58504

Date	10/16/2025 2:30 PM
Ship Via	
PO Number	mcdowell

Counter #	Customer #	Ordered By	Special Instructions
843506	806814		

Qty	Line	Item Number	Description	Warr	Unit	Tax	List	Net	Extended
1	SYL	H11LEDHPBX2	LED CAPSULE	LT	BX	N	169.47	89.77	89.77
1	LUC	10011	STOP LEAK	MD	EA	N	45.75	26.99	26.99

*lights* → *Power Steering*

COPY

2 Items

We have lobby posters to help promote your services! Ask Sales Rep for details.

Chip Used: Y A0000000031010 000000000 06011203A00000 Verified By Not Verified REF #: 895579637344 AUTH CD: 019935

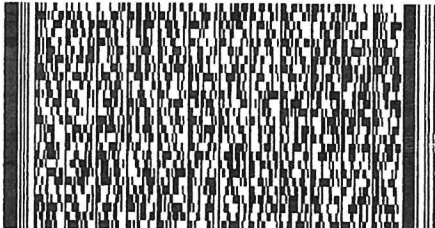

Sub-Total	116.76
Sales Tax	0.00
<b>Total</b>	<b>116.76</b>
VISA #6485	116.76

WWW.OREILLYPRO.COM

Warranty/Garantia: [www.oreillypro.com/warranty](http://www.oreillypro.com/warranty)

WE APPRECIATE YOUR BUSINESS!

1536WS150 Remit To: PO BOX 9464, SPRINGFIELD, MO 65801-9464



Oct 17, 2025 order  
Order# 2000139-83538185



Uxcell 2Pcs Silicone Heating Pad, 220V 150W Car Engine Block Oil Pan Heater Heater Strip for Constant Temperature 127mm x 102mm Qty 1 \$20.09

**Subtotal** \$22.99

Savings **-\$2.90**

**\$20.09**

Tax \$0.00

**Total** **\$20.09**

 **Charge history** Your transaction activity for this order >

Payment method  Ending in 6485

Your payment method has a temporary hold for \$20.09. An updated charge will appear on your statement within 10 business days.

COPY



KEEP YOUR RECEIPT  
RETURN POLICY VARIES BY PRODUCT TYPE

Unless noted below allowable returns for  
items on this receipt will be in the form  
of an in store credit voucher if the  
return is done after 01/09/26

If you have questions regarding the  
charges on your receipt, please

email us at:

BISMfrontend@menards.com



Sale Transaction

Tax Exempt Certificate ID: 5021339  
Exempt Type: State or Local Government

1G 2-1/4" WIU COVER - CL		
3614149		
2G 3-1/8" WIU COVER - CL		
3614165		
CLR 1-GNG NM WIU DEEP CV		
3615924		

*Electrical*

	10.44	NT
	16.70	NT
	15.98	NT

TOTAL SALE 43.12

VISA CREDIT 6485 43.12

PO # mcdowell

Auth Code:040149

Contactless

a0000000031010

ARQC - 169d169102fb0638

TOTAL NUMBER OF ITEMS = 3

**COPY**

THE FOLLOWING REBATE RECEIPTS WERE  
PRINTED FOR THIS TRANSACTION.  
3732

GUEST COPY

The Cardholder acknowledges receipt of  
goods/services in the total amount shown  
hereon and agrees to pay the card issuer  
according to its current terms.

THIS IS YOUR CREDIT CARD SALES SLIP  
PLEASE RETAIN FOR YOUR RECORDS.

THANK YOU, YOUR CASHIER, Destiny

21947 01 4657 10/11/25 10:19AM 3055



701 South Washington  
Bismarck, ND 58504  
701-223-9582

PROD ID	QTY	UM	PRICE	TOTAL
PROPANE TANK	16	OZ 2 PK		
92510922	1	EA	9.99	9.99
TWIST DRILL BIT SET 2" IMPACT	1	EA	9.99	29.99
8819251	1	EA	22.99	22.99
PUNCH CHISEL AWL 12PC SET	1	EA	22.99	22.99
28300740				
SUBTOTAL				62.97
Tax				0.00
TOTAL				62.97
Visa				62.97
xxxxxxxxxxxx6485 (Approved)				
ROBINSON/DAVID				

10/02/25 15:26:11 016 83110453016  
1610111 BISMARCK PARKS & RECREATION  
ATB: \*ALL NEED A PO  
GOV: 1610111  
PO NUMBER: McDowell Dam  
INVOICE #: 7079196 WSID: RWS01092  
2AC7B702-53ED-4DA4-B88F-27657BABDD63  
5714SS 5.3.25.319 TILL ID: 03  
Thanks for choosing Runnings!

Earn rewards for every purchase.  
Apply for the NEW Runnings Mastercard®



COPY

3300 State Street  
Bismarck, ND 58503

KEEP YOUR RECEIPT  
RETURN POLICY VARIES BY PRODUCT TYPE

Unless noted below allowable returns for  
items on this receipt will be in the form  
of an in store credit voucher if the  
return is done after 01/22/26

If you have questions regarding the  
charges on your receipt, please  
email us at:  
BISMfrontend@menards.com



Sale Transaction

Tax Exempt Certificate ID: 5021339  
Exempt Type: State or Local Government

DYNAFLEX 230 CAULK  
5638841 6.28 NT

Tax Exempt Certificate ID: 5021339  
Exempt Type: State or Local Government

ORDER 30256

6"X12' R/S FASCIA .019 -PICK  
1572278 19.96 NT  
END OF ORDER *Shower*

*House*  
TOTAL SALE 26.26  
VISA CREDIT 6485 26.26  
PD # mcdowel  
Auth Code:073004  
Contactless  
a0000000031010  
ARQC - a2ba443dd6d4dbb4

COPY

TOTAL NUMBER OF ITEMS = 2

THE FOLLOWING REBATE RECEIPTS WERE  
PRINTED FOR THIS TRANSACTION:  
3734

GUEST COPY

The Cardholder acknowledges receipt of  
goods/services in the total amount shown  
hereon and agrees to pay to card issuer  
according to its current terms.

THIS IS YOUR CREDIT CARD SALES SLIP  
PLEASE RETAIN FOR YOUR RECORDS.



3300 State Street  
Bismarck, ND 58503

~ KEEP YOUR RECEIPT  
RETURN POLICY VARIES BY PRODUCT TYPE

Unless noted below allowable returns for  
items on this receipt will be in the form  
of an in store credit voucher if the  
return is done after 01/13/26

If you have questions regarding the  
charges on your receipt, please  
email us at:  
BISMfrontend@menards.com



Sale Transaction

Tax Exempt Certificate ID: 2724111  
Exempt Type: null  
12PC PUNCH AND CHISEL SE\* LW  
2440375 8.98 NT  
240 DEG 2HEAD COV DUALUX  
3569228 *motion light* 29.97 NT

Tax Exempt Certificate ID: 5021339  
Exempt Type: State or Local Government

GBT CLEAR WOOD PROTECTOR\*  
5533257 *Stain 5 gallons* 160.00 NT

Tax Exempt Certificate ID: 5021339  
Exempt Type: State or Local Government

ORDER 26878

16"X12' PRO VENTED SOFFIT-PICK\*  
1572140 2 @29.20 58.40 NT  
END OF ORDER

TOTAL SALE 257.35  
VISA CREDIT 6485 257.35  
PD # mcdowell  
Auth Code:039502  
Contactless  
a0000000031010  
ARQC - 1b4cbff7f9293555

TOTAL SAVINGS 60.57

TOTAL NUMBER OF ITEMS = 5

THE FOLLOWING REBATE RECEIPTS WERE  
PRINTED FOR THIS TRANSACTION:  
3733

GUEST COPY

The Cardholder acknowledges receipt of  
goods/services in the total amount shown

COPY

Phone: (701) 222-6455 • Fax (701) 221-6838

Federal ID Number: 45-0409352

ORIGINAL



**DEDICATED TO THE PROFESSIONAL**

Store 1536, 2201 E BISMARCK EXPY,  
BISMARCK, ND 58504 (701) 258-8755

**Bill To:**

**BISMARCK PARKS AND RECRE**

400 E FRONT AVE

BISMARCK, ND 58504

Invoice	1536-137838
Sale Type	CHARGE SALE
Date	11/01/2025 4:04 PM
Ship Via	
PO Number	McDowell

Counter #	Customer #	Ordered By	Special Instructions
821164	806814	Seth	

Qty	Line	Item Number	Description	Warr	Unit	Tax	List	Net	Extended
2	WIX	51365	OIL FILTER	1Y	EA	N	25.41	7.93	15.86
2	WIX	33263	FUEL FILTER	1Y	EA	N	42.36	12.53	25.06
DC or Hub Pickup									
This item has been ordered:									
1 from DC 16 MINNEAPOLIS									
Estimated In Store 11/4/2025 7:30 AM									
3	WIX	42985	HD AIR FLTR	1Y	EA	N	77.95	25.22	75.66
DC or Hub Pickup									
This item has been ordered:									
2 from DC 16 MINNEAPOLIS									
Estimated In Store 11/4/2025 7:30 AM									
3	WIX	46438	HD AIR FLTR	1Y	EA	N	76.25	28.09	84.27
DC or Hub Pickup									
This item has been ordered:									
2 from DC 16 MINNEAPOLIS									
Estimated In Store 11/4/2025 7:30 AM									
1	WIX	57682	HYD FILTER	1Y	EA	N	83.03	14.74	14.74
DC or Hub Pickup									
This item has been ordered:									
1 from DC 16 MINNEAPOLIS									
Estimated In Store 11/4/2025 7:30 AM									
1	WIX	33507	FUEL FILTER	1Y	EA	N	40.66	12.94	12.94

12 Items

Power Torque Tools, engineered for the Professional technician.

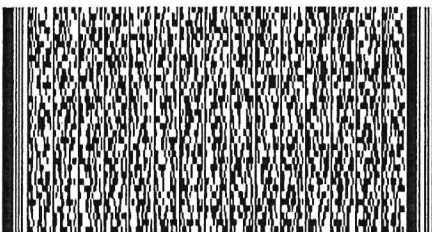

Sub-Total 228.53

WWW.OREILLYPRO.COM

WE APPRECIATE YOUR BUSINESS!

Warranty/Returns: www.oreillypro.com/warranty

1/2

1536WS153 2201 E BISMARCK EXPY 58504 BISMARCK ND 58504-0464





**DEDICATED TO THE PROFESSIONAL**

Store 1536, 2201 E BISMARCK EXPY,  
BISMARCK, ND 58504 (701) 258-8755

**Bill To:**

**BISMARCK PARKS AND RECRE**  
400 E FRONT AVE

BISMARCK, ND 58504

Invoice	1536-137838
Sale Type	CHARGE SALE
Date	11/01/2025 4:04 PM
Ship Via	
PO Number	McDowell

Counter #	Customer #	Ordered By	Special Instructions
821164	806814	Seth	

Qty	Line	Item Number	Description	Warr	Unit	Tax	List	Net	Extended
1	WIX	46490	HD AIR FLTR	1Y	EA	N	89.81	31.47	31.47
			DC or Hub Pickup						
			This item has been ordered:						
			1 from DC 16 MINNEAPOLIS						
			Estimated In Store 11/4/2025 7:30 AM						
1	WIX	46489	HD AIR FLTR	1Y	EA	N	116.93	41.79	41.79
			DC or Hub Pickup						
			This item has been ordered:						
			1 from DC 16 MINNEAPOLIS						
			Estimated In Store 11/4/2025 7:30 AM						

2 Items

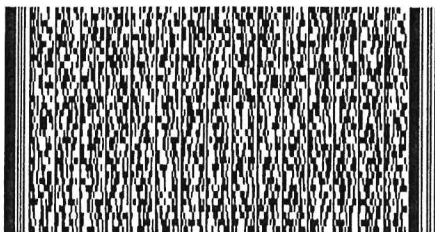

X  
Customer Signature



Sub-Total	301.79
Sales Tax	0.00
<b>Total</b>	<b>301.79</b>

WWW.OREILLYPRO.COM

Warranty/Garantia: [www.oreillypro.com/warranty](http://www.oreillypro.com/warranty)

WE APPRECIATE YOUR BUSINESS!

1536WC153 B-114 Tel: 701.258.8464 SPRINGFIELD, MO 65801 0464



**DEDICATED TO THE PROFESSIONAL**

Store 1536, 2201 E BISMARCK EXPY,  
BISMARCK, ND 58504 (701) 258-8755

Bill To:

**BISMARCK PARKS AND RECRE**  
400 E FRONT AVE

BISMARCK, ND 58504

Invoice	1536-137834
Sale Type	CHARGE SALE
Date	11/01/2025 3:57 PM
Ship Via	
PO Number	McDowell

Counter #	Customer #	Ordered By	Special Instructions
821164	806814	Seth	

Qty	Line	Item Number	Description	Warr	Unit	Tax	List	Net	Extended
1	BOS	22WT	WINTER BLADE	1Y	EA	N	37.27	19.00	19.00
1	BOS	22WT	WINTER BLADE	1Y	EA	N	37.27	19.00	19.00
1	VCC	929200	100PK MICRO	MD	PK	N	72.86	42.99	42.99
1	ORO	10-30-5QT	5QTMOTOROIL	MD	EA	N	42.36	24.99	24.99
1	CTI	84896	TOGGLE SWTCH	1Y	CD	N	23.71	13.99	13.99

5 Items

Power Torque Tools, engineered for the Professional technician.

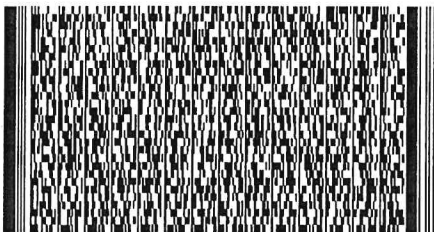

X

Customer Signature



Sub-Total	119.97
Sales Tax	0.00
<b>Total</b>	<b>119.97</b>

WWW.OREILLYPRO.COM

WE APPRECIATE YOUR BUSINESS!

**BISMARCK PARKS AND RECREATION DISTRICT**

No. 105608

North Dakota

ND Tax Exempt Number: E-4674  
Federal ID Number: 45-0409352

Name \_\_\_\_\_

**Vendor**

### Address

Date \_\_\_\_\_

## Notes

		Project Number	Cost
Acct #	01.12.000.531400		
Description	Cement Garbage cans		200.00
Acct #			
Description			
Acct #			
Description			
Acct #			
Description			
Acct #			
Description			
Acct #			
Description			
Acct #			
Description			
Acct #			
Description			
<div> <div>Employee's Signature</div>  </div>		Total	200.00

**Employee's Signature**

**Manager's Signature**

**Total**

**Approved By**

ORIGINAL



Printed On: 10/16/2025

Page 1 of 1

Document Number: 167093 / 35239  
BISMARCK PARKS AND RECREATION  
DAVID ROBINSON  
400 EAST FRONT AVENUE

Number: BISO012

10/16/2025

BISMARCK, NORTH DAKOTA 58504  
Phone: (701) 222-6455

Inventory Number	Description of Property	Qty Unit	Cost	Handling Charge
S-25-167076-003	garbage cans	2	\$100.00	\$200.00

NDSASP REP: RANDY  
Remarks:

Total: \$200.00  
Amount Applied: \$0.00  
Total Due: \$200.00

For  
Change  
Rooms

By signing and submitting this lower tier proposal, the prospective lower tier participant, as defined in 41 CFR 105-68, certifies to the best of its knowledge and belief that it and its principals are not presently debarred, suspended, proposed for debarment, declared ineligible, or voluntarily excluded from participation in this transaction by any Federal department or agency and where the prospective lower tier participant is unable to certify to any of the above, such prospective participant shall attach an explanation to this proposal.

**THIS IS YOUR INVOICE**  
**Remit To**

North Dakota Surplus Property  
600 East Boulevard Ave., Dept. 15  
Bismarck, ND 58505-0608

As the authorized agent of the above donee, I accept the property listed above and commit the donee to comply with the terms and conditions printed on the other side of this document.

SIGNATURE

**PURCHASE ORDER**  
**BISMARCK PARKS AND RECREATION DISTRICT**  
400 East Front Avenue • Bismarck, ND 58504  
Phone: (701) 222-6455 • Fax (701) 221-6838

No. 105609

ND Tax Exempt Number: E-4674  
Federal ID Number: 45-0409352

Name

*Pakota Fire Station*

Vendor

*260*

Address

Date

*11/10/25*

Notes

*Fire extinguishers*

		Project Number	Cost
Acct #	<i>01.12.000.531400</i>		
Description	<i>Annual inspection of extinguishers</i>		<i>110.25</i>
Acct #			
Description			
Acct #			
Description			
Acct #			
Description			
Acct #			
Description			
Acct #			
Description			
Acct #			
Description			
Acct #			
Description			
Total			<i>110.25</i>

Employee's Signature

*[Signature]*

Manager's Signature

*[Signature]*

Approved By

*[Signature]*

ORIGINAL

**DAKOTA FIRE STATION, INC**  
**820 AIRPORT RD.**  
**BISMARCK, ND 58504**

## Invoice

Date	11/5/2025
Invoice #	81319
Due Date	11/20/2025
Terms	NET 15
P.O. #	
Rep	DEREK

Bill To

**BISMARCK PARKS & REC**  
**400 E FRONT AVE**  
**BISMARCK ND 58504**

Ship To

**MCDOWELL DAM**  
**DAVID ROBINSON 223-7016**  
**226-4955**

Item	Qty	Description	Rate	Amount
		BROUGHT IN FOR SERVICE ON 11/5/25		
AN10	1	ANNUAL INSPECTION OF A 10# FIRE EXTINGUISHER	10.00	10.00
AN5	6	ANNUAL INSPECTION OF A 5# FIRE EXTINGUISHER	10.00	60.00
HD2.5	1	12 YEAR HYDROTEST OF A 2.5# DRY CHEMICAL FIRE EXT	13.50	13.50
RD2.5	1	RECHARGE OF A 2.5# DRY CHEMICAL FIRE EXT.	13.50	13.50
TASC2	1	GREY VERIFICATION OF SERVICE COLLAR	1.00	1.00
OR28	1	ANSUL ORING	2.25	2.25
VL415202AS/...	1	ANSUL VALVE	10.00	10.00

Please provide updated information on this invoice and include it with your payment, or contact us at the information provided below.

**Subtotal** \$110.25

**Sales Tax (0.0%)** \$0.00

Would you like to receive your invoice via email?    yes    no  
E-mail:

**Balance Due** \$110.25

HD: \_\_\_\_\_ 6YR: \_\_\_\_\_ RPLC: \_\_\_\_\_

Thank you for your business. Please pay from this invoice.

Tel.: 701-222-0242 | E-mail: [service@dakotafirestation.com](mailto:service@dakotafirestation.com) | Web: [dakotafirestation.com](http://dakotafirestation.com)



**PURCHASE ORDER**  
**BISMARCK PARKS AND RECREATION DISTRICT**  
 400 East Front Avenue • Bismarck, ND 58504  
 Phone: (701) 222-6455 • Fax (701) 221-6838

No. 105606

ND Tax Exempt Number: E-4674  
 Federal ID Number: 45-0409352

Name Rowlings

Vendor 785

Address \_\_\_\_\_  
 \_\_\_\_\_  
 \_\_\_\_\_

Date 11/4/25

Notes Hand tools  
 \_\_\_\_\_  
 \_\_\_\_\_  
 \_\_\_\_\_

531700		Project Number	Cost
Acct #	01.12-000-531400		29.98
Description	Locking long nose pliers x2		
Acct #			
Description			
Acct #			
Description			
Acct #			
Description			
Acct #			
Description			
Acct #			
Description			
Acct #			
Description			
Acct #			
Description			
Total			29.98

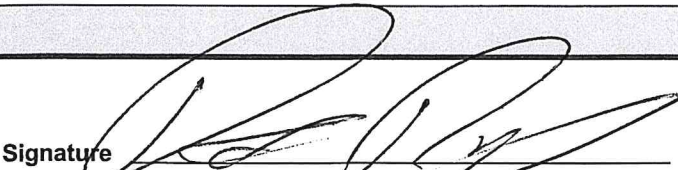
Employee's Signature 

Manager's Signature 

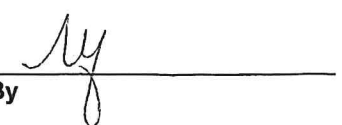
Approved By 



701 South Washington  
Bismarck, ND 58504  
701-223-9582

PROD ID	QTY	UM	PRICE	TOTAL
PLIERS LONG NOSE LOCKING 15"				
28303462	2	EA	14.99	29.98 n
SUBTOTAL				29.98
Tax				0.00
TOTAL				29.98
Charge Account				29.98

10/30/25 18:51:04 016 83390708016  
1610111 BISMARCK PARKS & RECREATION  
ATB: \*ALL NEED A PO  
GOV: 1610111  
PO NUMBER: mcdowell  
INVOICE #: 7099541 WSID: RWS01092  
E5D365DC-CD56-4887-BD4B-6AD6078E9FCE  
1000TG 5.3.25.910 TILL ID: 03

Thanks for choosing Runnings!

Earn rewards for every purchase.  
Apply for the NEW Runnings Mastercard®





A Touchstone Energy® Cooperative

7401 Yukon Drive  
Bismarck, ND 58503  
Office: (701) 223-1513  
Payments: (855) 937-1736  
www.capitalelec.com

Statement Date  
Account Number  
Due Date

11/14/2025  
868001  
11/28/2025

### Billing Summary

Previous Balance	\$284.56
Payment(s) Received	<u>Thank You!</u> \$-284.56
Balance Forward	\$0.00
Charges	\$270.66
<b>Amount Due</b>	<b>\$270.66</b>

BIS CITY PARK DISTRICT  
PARKS & REC  
400 E FRONT AVE  
BISMARCK ND 58504-5641

Message(s) On-Peak Occurred: 10/29/2025 8:00 AM - 8:30 AM  
Grid Capacity Occurred: 02/17/2025

Service Address: SEC 27SW MCDOWELL HOUSE

Meter #	Rate Description	From	To	Days	Previous	Present	Mult.	kWh	kW
86861804	COINCIDENT PEAK	10/01/2025	11/01/2025	31	152833	154938	1	2105	5.382

### Detail of Charges

Monthly Base		\$24.00
Energy	2105 kWh @ \$0.03583	\$75.42
On-Peak Demand	5.382 kW @ \$24.70	\$132.94
Grid Capacity	14.184 kW @ \$2.70	\$38.30
<b>Current Charges</b>		<b>\$270.66</b>

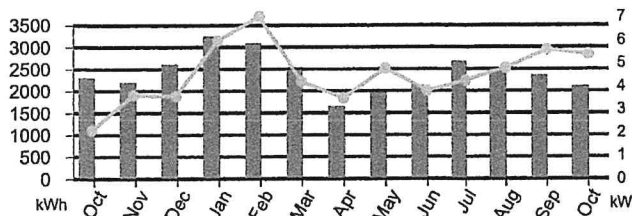

PERIOD ENDING	OCT 2024	OCT 2025
Avg Daily Temp	51	51
Avg Daily kWh	74	68

RETURN BOTTOM PORTION WITH YOUR PAYMENT. PLEASE DO NOT FOLD, STAPLE, TAPE, OR PAPERCLIP.

Capital Electric Cooperative is an equal opportunity provider and employer.

BIS CITY PARK DISTRICT  
PARKS & REC  
400 E FRONT AVE  
BISMARCK ND 58504-5641  
PRIMARY: (701) 222-6455

SECONDARY:

Account Number  
Due Date  
Amount Due

868001  
11/28/2025  
\$270.66

Please notify us of any changes to your account information below:

---



---



---

CAPITAL ELECTRIC COOPERATIVE, INC.  
PO BOX 730  
BISMARCK ND 58502-0730



360350000868001000027066000027472111420250





A Touchstone Energy® Cooperative

7401 Yukon Drive  
Bismarck, ND 58503  
Office: (701) 223-1513  
Payments: (855) 937-1736  
www.capitalelec.com

Statement Date  
Account Number  
Due Date

11/14/2025  
868002  
11/28/2025

### Billing Summary

Previous Balance	\$366.74
Payment(s) Received	<i>Thank You!</i> \$-366.74
Balance Forward	\$0.00
Charges	\$271.25
<b>Amount Due</b>	<b>\$271.25</b>

BIS CITY PARK DISTRICT  
PARKS & REC  
400 E FRONT AVE  
BISMARCK ND 58504-5641

Message(s) On-Peak Occurred: 10/29/2025 8:00 AM - 8:30 AM  
Grid Capacity Occurred: 07/21/2025

Service Address: SEC 27 MCDOWELL REC AREA

Meter #	Rate Description	From	To	Days	Previous	Present	Mult.	kWh	kW
78904864	COINCIDENT PEAK	10/01/2025	11/01/2025	31	4406	4455	40	1960	5.680

### Detail of Charges

Monthly Base		\$24.00
Energy	1960 kWh @ \$0.03583	\$70.23
On-Peak Demand	5.68 kW @ \$24.70	\$140.30
Grid Capacity	13.6 kW @ \$2.70	\$36.72
<b>Current Charges</b>		<b>\$271.25</b>

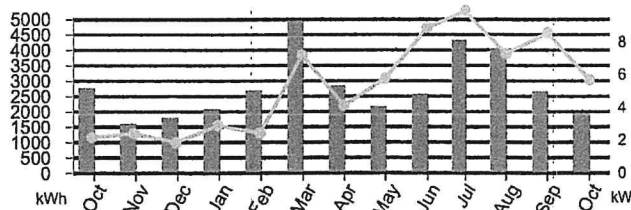

PERIOD ENDING	OCT 2024	OCT 2025
Avg Daily Temp	51	51
Avg Daily kWh	89	63

RETURN BOTTOM PORTION WITH YOUR PAYMENT. PLEASE DO NOT FOLD, STAPLE, TAPE, OR PAPERCLIP.

Capital Electric Cooperative is an equal opportunity provider and employer.

BIS CITY PARK DISTRICT  
PARKS & REC  
400 E FRONT AVE  
BISMARCK ND 58504-5641  
PRIMARY: (701) 222-6455

SECONDARY:

Account Number  
Due Date  
Amount Due

868002  
11/28/2025  
\$271.25

Please notify us of any changes to your account information below:

---



---



---

CAPITAL ELECTRIC COOPERATIVE, INC.  
PO BOX 730  
BISMARCK ND 58502-0730





A Touchstone Energy® Cooperative

7401 Yukon Drive  
Bismarck, ND 58503  
Office: (701) 223-1513  
Payments: (855) 937-1736  
www.capitalelec.com

Statement Date  
Account Number  
Due Date

11/14/2025  
868029  
11/28/2025

### Billing Summary

Previous Balance	\$36.65
Payment(s) Received	<u>Thank You!</u> \$-36.65
Balance Forward	\$0.00
Charges	\$35.11
<b>Amount Due</b>	<b>\$35.11</b>

BIS CITY PARK DISTRICT  
PARKS & REC  
400 E FRONT AVE  
BISMARCK ND 58504-5641

Message(s) On-Peak Occurred: 10/29/2025 8:00 AM - 8:30 AM  
Grid Capacity Occurred: 09/27/2025

Service Address: 1951 NE 93RD ST

Meter #	Rate Description	From	To	Days	Previous	Present	Mult.	kWh	kW
93622953	RURAL RESIDENTIAL/SMALL COMM	10/01/2025	11/01/2025	31	4050	4088	1	38	0.016

### Detail of Charges

Monthly Base		\$31.00
Energy	38 kWh @ \$0.08161	\$3.10
On-Peak Demand	0.016 kW @ \$5.00	\$0.08
Grid Capacity	0.464 kW @ \$2.00	\$0.93
<b>Current Charges</b>		<b>\$35.11</b>

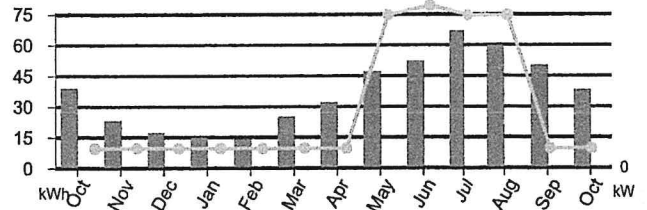

PERIOD ENDING	OCT 2024	OCT 2025
Avg Daily Temp	51	51
Avg Daily kWh	1	1

RETURN BOTTOM PORTION WITH YOUR PAYMENT. PLEASE DO NOT FOLD, STAPLE, TAPE, OR PAPERCLIP.

Capital Electric Cooperative is an equal opportunity provider and employer.

BIS CITY PARK DISTRICT  
PARKS & REC  
400 E FRONT AVE  
BISMARCK ND 58504-5641  
PRIMARY: (701) 222-6455

SECONDARY:

Account Number  
Due Date  
Amount Due

868029  
11/28/2025  
\$35.11

Please notify us of any changes to your account information below:

---



---



---



---

CAPITAL ELECTRIC COOPERATIVE, INC.  
PO BOX 730  
BISMARCK ND 58502-0730

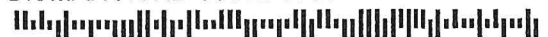

360350000868029000003511000003564111420255



200 EAST BROADWAY  
PO BOX 230  
STEELE, ND 58482  
1.888.475.2361

BILLING NO: (701)223-7016

ACCOUNT NO: 1205800

# **BILL AT A GLANCE 10/01/2025** **BISMARCK PARKS & REC**

BALANCE FROM LAST BILLING		172.82
Payments Received	09-03	172.82CR
Previous Balance Due		.00

## **SUMMARY BY SERVICE TYPE**

BUSINESS LINE METERED	64.00
VOICE SERVICES	8.24CR
INTERNET SERVICES	66.50
MANDATED FEES	4.06
MISCELLANEOUS SERVICES	46.50
INTERNET SERVICES	.00

<b>CURRENT BILLING AMOUNT</b>	<b>172.82</b>
-------------------------------	---------------

<b>Credit Card Payment -- Do Not Pay</b>	<b>172.82</b>
--	---------------

Previous Bill	Payment/Adj	Current Billing	Total Due
\$172.82	\$172.82CR	\$172.82	\$172.82

## **MESSAGE CENTER**

Billing Inquiries Call: 1(888)475-2361

Payments received after 09-30 have not been applied to this statement.

To pay by credit card using BEK's Pay-by-Phone System, please call 1-855-941-3552 toll-free. Have your credit card and BEK account number ready.

The CURRENT AMOUNT of your BEK payment is due by the 20th day of each month. If you have an unpaid balance, it will be applied to your next statement plus a \$30 late fee. PAST DUE accounts are subject to disconnection on OCTOBER 21, 2025 unless payment or arrangements have been made prior. If your services are disconnected for nonpayment, you will be required to pay all past due balances including reconnect charges.

Payment of this invoice constitutes acceptance of the Terms and Conditions of BEK Communications services. These Terms and Conditions should be reviewed periodically as they will change from time to time and can be found at [www.bek.coop](http://www.bek.coop) or by request at 1-888-475-2361.

Federal Universal Service Charge (FUSC): In a recent order, the Federal Communications Commission (FCC) changed the FUSC factor from 36.0% to 38.1% effective October 1, 2025. The purpose of this charge is to help keep rates affordable for all customers, regardless of where they live in the U.S. as well as to assist schools, libraries and rural healthcare providers obtain leading edge telecommunications services. This current rate of 38.1% of specific regulatory and tariff fees is set by the FCC and is subject to change upon their discretion.

Looking for ways to grow your community? Explore grant opportunities at [bek.coop/grants](http://bek.coop/grants)!

(Continued on subsequent pages)

Please return lower portion with your payment...retain upper portion for your records.  
Please do not attach payment to the stub.



200 EAST BROADWAY  
PO BOX 230  
STEELE, ND 58482  
1.888.475.2361

10/01/2025 000000

BISMARCK PARKS & REC  
ACCOUNT NO: 1205800 BS  
BILLING NO: (701)223-7016

Payment Due	Total Due
Invoiced	\$172.82
Enter Amount Paid	
Credit Card	

BISMARCK PARKS & REC  
400 EAST FRONT  
BISMARCK ND 58504

4 3506

BEK COMMUNICATIONS COOPERATIVE  
200 EAST BROADWAY  
PO BOX 230  
STEELE ND 58482-0230



3652900000120580070122370160000172826





200 EAST BROADWAY  
PO BOX 230  
STEELE, ND 58482  
1.888.475.2361

Page: 3 of 3  
BISMARCK PARKS & REC  
ACCOUNT NO: 1205800

**MONTHLY USAGE FOR BILLING NO: (701)223-7016 MEMBER NO: 22308**

Service Address: 1951 93 ST NE BISMARCK, ND

Description	Qty	Amount
<b>SUMMARY FOR: McDowell Dam</b>		
Previous Balance Due		.00
BUSINESS LINE METERED 10/01-10/31		32.00
BUSINESS LINE		
CALLER ID		
TOLL RESTRICTION		
BUSINESS LINE METERED SUBTOTAL		32.00
<b>VOICE SERVICES 10/01-10/31</b>		
MULTIPLE PRODUCT CREDIT - BASIC PHONE	1	- 5.00
FEDERAL TAX		-.15
VOICE SERVICES SUBTOTAL		- 5.15
<b>MANDATED FEES 10/01-10/31</b>		
E911 FEE-BURLEIGH CO	1	2.00
TELECOMMUNICATIONS RELAY SERVICE FUND	1	.03
MANDATED FEES SUBTOTAL		2.03
<b>MISCELLANEOUS SERVICES 10/01-10/31</b>		
60 MONTH TERM AGREEMENT		
YOUR 60 MONTH TERM AGREEMENT EXPIRES ON 04/30/30		
MISCELLANEOUS SERVICES SUBTOTAL		.00
SUB-TOTAL		28.88
CURRENT BILLING AMOUNT		28.88
Credit Card Payment -- Do Not Pay		
Your long distance (InterLATA) provider is BEK LD.		
Your long distance (IntraLATA) provider is BEK LD.		

**MONTHLY USAGE FOR BILLING NO: (701)255-7385 MEMBER NO: 22308**

Service Address: 1951 93 ST NE STR 1 BISMARCK, ND

Description	Qty	Amount
<b>SUMMARY FOR: McDowell Dam-Concession/Shop</b>		
Previous Balance Due		.00
BUSINESS LINE METERED 10/01-10/31		32.00
BUSINESS LINE		
CALLER ID		
TOLL RESTRICTION		
BUSINESS LINE METERED SUBTOTAL		32.00
<b>VOICE SERVICES 10/01-10/31</b>		
MULTIPLE PRODUCT CREDIT - BASIC PHONE	1	- 5.00
ON PREMISE EXTENSION - PHONE ONLY	1	2.00
FEDERAL TAX		-.09
VOICE SERVICES SUBTOTAL		- 3.09
<b>MANDATED FEES 10/01-10/31</b>		
E911 FEE-BURLEIGH CO	1	2.00
TELECOMMUNICATIONS RELAY SERVICE FUND	1	.03
MANDATED FEES SUBTOTAL		2.03
<b>MISCELLANEOUS SERVICES 10/01-10/31</b>		
60 MONTH TERM AGREEMENT		
YOUR 60 MONTH TERM AGREEMENT EXPIRES ON 04/30/30		
MISCELLANEOUS SERVICES SUBTOTAL		.00
SUB-TOTAL		30.94
CURRENT BILLING AMOUNT		30.94
Credit Card Payment -- Do Not Pay		
Your long distance (InterLATA) provider is BEK LD.		
Your long distance (IntraLATA) provider is BEK LD.		

**MONTHLY USAGE FOR BILLING NO: 701-101-2047 MEMBER NO: 22308**

Service Address: 1951 93 ST NE BISMARCK, ND

Description	Qty	Amount
<b>SUMMARY FOR: McDowell Dam</b>		
Previous Balance Due		.00
<b>INTERNET SERVICES 10/01-10/31</b>		
MULTIPLE PRODUCT CREDIT - INTERNET	1	- 5.00
INTERNET PROMO 10/01		- 30.00
YOUR INTERNET PROMO EXPIRES ON 04/30/26		
BUSINESS 1/2 GBPS LIGHTBAND	1	101.50
INTERNET SERVICES SUBTOTAL		66.50
<b>MISCELLANEOUS SERVICES 10/01-10/31</b>		
60 MONTH TERM AGREEMENT		
YOUR 60 MONTH TERM AGREEMENT EXPIRES ON 04/30/30		

E-BILL & AUTO PAY CREDIT	1	- 5.00
MISCELLANEOUS SERVICES SUBTOTAL		- 5.00
<b>INTERNET SERVICES</b>		
BROADBAND USAGE - 158.67 GBS 09/30		
INTERNET SERVICES SUBTOTAL		.00
SUB-TOTAL		61.50
CURRENT BILLING AMOUNT		61.50
Credit Card Payment -- Do Not Pay		
61.50		

**MONTHLY USAGE FOR BILLING NO: 701-161-2230 MEMBER NO: 22308**

Service Address: 1951 93 ST NE STR 2 BISMARCK, ND

Description	Qty	Amount
<b>SUMMARY FOR: McDowell Dam</b>		
Previous Balance Due		.00
<b>MISCELLANEOUS SERVICES 10/01-10/31</b>		
60 MONTH TERM AGREEMENT		
YOUR 60 MONTH TERM AGREEMENT EXPIRES ON 04/30/30		
MULTI-LOCATION SERVICES	1	25.00
MULTI-LOCATION SERVICES - 1/2G LIGHTBAND		
FEDERAL TAX		.75
MISCELLANEOUS SERVICES SUBTOTAL		25.75
SUB-TOTAL		25.75
CURRENT BILLING AMOUNT		25.75
Credit Card Payment -- Do Not Pay		
25.75		

**MONTHLY USAGE FOR BILLING NO: 701-161-2431 MEMBER NO: 22308**

Service Address: 1951 93 ST NE STR 1 BISMARCK, ND

Description	Qty	Amount
<b>SUMMARY FOR: McDowell Dam</b>		
Previous Balance Due		.00
<b>MISCELLANEOUS SERVICES 10/01-10/31</b>		
60 MONTH TERM AGREEMENT		
YOUR 60 MONTH TERM AGREEMENT EXPIRES ON 04/30/30		
MULTI-LOCATION SERVICES	1	25.00
MULTI-LOCATION SERVICES - PHONE		
MULTI-LOCATION SERVICES - 1/2G LIGHTBAND		
FEDERAL TAX		.75
MISCELLANEOUS SERVICES SUBTOTAL		25.75
SUB-TOTAL		25.75
CURRENT BILLING AMOUNT		25.75
Credit Card Payment -- Do Not Pay		
25.75		



No. 105610

Federal ID Number \_\_\_\_\_  
Name Better Roofing

Vendor 6036

Date 11.10.25

Notes Metal Roofing - pr quote

		Project Number	Cost
Acct #	01.12.000.570100		
Description	Replace @ roofs on 1, 3 and 4 buildings		44,129.25
Acct #			
Description			
Acct #			
Description			
Acct #			
Description			
Acct #			
Description			
Acct #			
Description			
Acct #			
Description			
Acct #			
Description			
		Total	44,129.25

**Employee's Signature**

**Manager's Signature**

Approved By \_\_\_\_\_

ORIGINAL



Better Roofing & Contracting  
3115 East Broadway Avenue,  
Bismarck, ND 58501  
701-751-7663

# INVOICE

Job: 25-5843: David Mayer  
Invoice Name: Bis Parks & Rec  
Invoice Number: 25-5843-1  
Invoice Date: 11/07/2025  
Terms: Upon Receipt

Location Address  
400 East Front Avenue  
Bismarck, ND 58504

David Mayer  
Bismarck Parks and Recreation District  
400 East Front Avenue  
Bismarck, ND 58504

PRICE

## ROOFING Insurance Claim

### Roofing Section

*Remove and Replace Metal Roofing on buildings at McDowell Dam  
bids 1,3,4  
Per agreed contract price*

Steep Slope - Labor (Bid Item)

<b>Subtotal: Roofing Section</b>	<b>\$44,129.25</b>
----------------------------------	--------------------

<b>Subtotal: Insurance Claim</b>	<b>\$44,129.25</b>
----------------------------------	--------------------

<b>Grand Total</b>	<b>\$44,129.25</b>
--------------------	--------------------

<b>Invoice Balance Due:</b>	<b>\$44,129.25</b>
-----------------------------	--------------------

**REMIT TO:**  
3115 East Broadway Avenue,  
Bismarck, ND 58501  
701-751-7663

**Company Representative:**  
Tyler Perry  
(701) 226-3314  
Tyler@betterroofingnd.com



**PURCHASE ORDER**  
**BISMARCK PARKS AND RECREATION DISTRICT**  
 400 East Front Avenue • Bismarck, ND 58504  
 Phone: (701) 222-6455 • Fax (701) 221-6838

**No. 105522**

ND Tax Exempt Number: E-4674  
 Federal ID Number: 45-0409352

**Name** Paramount Builders

**Vendor** 6818

**Address** \_\_\_\_\_  
 \_\_\_\_\_  
 \_\_\_\_\_

**Date** 10-3-25

**Notes**

McDowell Dam playground and concrete project  
per bid

Acct #	Project Number	Cost
<u>01.13.000.570800</u>	<u>251034</u>	
<u>McDowell Dam Playground Pmt #1 Final</u>		<u>129,658.00</u>
Acct #		
Description		
Acct #		
Description		
Acct #		
Description		
Acct #		
Description		
Acct #		
Description		
Acct #		
Description		
Acct #		
Description		
<b>Total</b>		<u>129,658.00</u>

**Employee's Signature** \_\_\_\_\_

**Manager's Signature** 

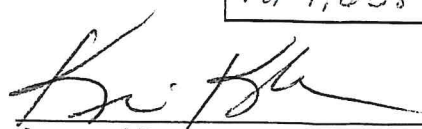
  
**Approved By**

ORIGINAL

# APPLICATION AND CERTIFICATE FOR PAYMENT

To: Bismarck Parks and Rec-  
Concrete  
400 E Front Ave  
Bismarck, ND 58504  
From: Paramount Builders Inc

Project: McDowell Dam  
Playground  
400 E Front Ave  
Bismarck, ND 58504

Application No: 1.0  
App. Date: May 22, 2025  
Period to: Sep 30, 2025  
Project No: 25216  
Contract Date:

Distribution to:  
☐ Owner  
☐ Architect  
☐ Contractor  
☐ Field  
☐ Other

Contract For:

Via Architect:

## CONTRACTOR'S APPLICATION FOR PAYMENT

Application is made for payment, as shown below, in connection with the Contract.  
Continuation Sheet is attached.

1. ORIGINAL CONTRACT SUM	129,658.00
2. NET CHANGE BY CHANGE ORDERS	0.00
3. CONTRACT SUM TO DATE	129,658.00
4. TOTAL COMPLETED AND STORED TO DATE	129,658.00
5. RETAINAGE:	
a. 0.00% of Completed work	0.00
b. 0.00% of Stored Material	0.00
TOTAL RETAINAGE	0.00
6. TOTAL EARNED LESS RETAINAGE	129,658.00
7. LESS PREVIOUS CERTIFICATES FOR PAYMENT	0.00
8. CURRENT PAYMENT DUE	129,658.00
9. BALANCE TO FINISH, INCLUDING RETAINAGE	0.00

The undersigned Contractor certifies that to the best of the Contractor's knowledge, information and belief the Work covered by this Application for Payment has been completed in accordance with the Contract Documents, that all amounts have been paid by the Contractor for Work for which previous Certificates for Payment were issued and payments received from the Owner, and that current payment shown herein is now due.

CONTRACTOR: Paramount Builders Inc  
By: \_\_\_\_\_ Date: 9-30-25

Subscribed and sworn before me this 30th day of September 2025

Notary Public:

My Commission expires: Notary Public

JENNIFER CHILLEMI

State of North Dakota

My Commission Expires Dec. 29, 2028

## ARCHITECT'S CERTIFICATE FOR PAYMENT

In accordance with the Contract Documents, based on on-site observations and the data comprising this application, the Architect certifies to the Owner that to the best of the Architect's knowledge, information and belief the Work has progressed as indicated, the quality of the Work is in accordance with the Contract Documents, and the Contractor is entitled to payment of the AMOUNT CERTIFIED.

AMOUNT CERTIFIED

(Attach explanation if amount certified differs from the amount applied for. Initial all figures on this Application and on the Continuation Sheet that are changed to conform to the amount certified.)

ARCHITECT:

By: \_\_\_\_\_ Date: \_\_\_\_\_

This Certificate is not negotiable. The AMOUNT CERTIFIED is payable only to the Contractor named herein. Issuance, payment and acceptance of payment are without prejudice to any rights of the Owner or Contractor under this Contract.

CHANGE ORDER SUMMARY	ADDITIONS	DEDUCTIONS
Total changed approved in previous months by owner	0.00	0.00
Total approval this month	0.00	0.00
TOTALS	\$0.00	\$0.00
NET CHANGES by Change Order	\$0.00	

Paramount Builders Inc  
1407 Tacoma Avenue  
Bismarck, ND 58504  
701-258-0088

# Bismarck Parks and Rec-Concrete

## APPLICATION AND CERTIFICATE FOR PAYMENT

Job No.: 25216  
Job: McDowell Dam Playground  
Application No: 1.0  
Application Date: May 22, 2025  
Period To: Sep 30, 2025

### CONTRACT

A	B	C	D	E	F	G		H	I
Item #	Description of Work	Scheduled Value	Work Completed		Materials Presently Stored	Total Completed and Stored To Date	%	Balance to Finish	Retainage (If Variable Rate)
			From Previous Application(s)	This Period					
01002	EQUIPMENT	950.40	0.00	950.40	0.00	950.40	100.00	0.00	0.00
01060	MANAGEMENT	4,873.29	0.00	4,873.29	0.00	4,873.29	100.00	0.00	0.00
01530	GENERAL LABOR	2,120.58	0.00	2,120.58	0.00	2,120.58	100.00	0.00	0.00
02000	SITE WORK SUBCONTRACT	2,673.00	0.00	2,673.00	0.00	2,673.00	100.00	0.00	0.00
02400	LANDSCAPING	7,056.72	0.00	7,056.72	0.00	7,056.72	100.00	0.00	0.00
03000	CONCRETE SUBCONTRACTOR	41,830.23	0.00	41,830.23	0.00	41,830.23	100.00	0.00	0.00
11300	SPECIALTY EQUIPMENT	70,153.78	0.00	70,153.78	0.00	70,153.78	100.00	0.00	0.00
		129,658.00	0.00	129,658.00	0.00	129,658.00	100.00	0.00	0.00

### ADDITIONS TO CONTRACT

	0.00	0.00	0.00	0.00	0.00	0.00	0.00	0.00
Grand TOTAL:	129,658.00	0.00	129,658.00	0.00	129,658.00	100.00	0.00	0.00





**South Central  
Regional Water  
District**

P.O. Box 4182  
Bismarck, ND 58502-4182

(701) 258-8710 • Fax (701) 223-6041  
Office Hours M-Th 8-4:30 and F 8-3  
www.southcentralwaternd.com

Account Number: 05790400-00  
Service Address: MCDOWELL DAM HOUSE  
Billing Date: 11/21/2025  
Current Charges: 57.70  
Past Due Charges: 0.00  
Amount Due by 12/10/2025: 57.70  
Amount Due After 12/10/2025: 61.70

☐ Check here if you have had a mailing address change  
and indicate this change on the back of the stub.



BISMARCK PARK DISTRICT  
400 E FRONT AVE  
BISMARCK ND 58504-5641

776 Web ID

Amount Enclosed: \_\_\_\_\_

PLEASE DETACH AND RETURN THIS PORTION WITH YOUR PAYMENT

Please Make Checks Payable to: SOUTH CENTRAL REGIONAL WATER or SCWD

Account Number: 05790400-00  
Service Address: MCDOWELL DAM HOUSE  
Last Payment: 133.55 - 10/30/2025  
Billing Date: 11/21/2025

BISMARCK PARK - MCDOWELL DAM  
400 E FRONT AVE  
BISMARCK ND 585045641

Current Reading: 11/01/2025 2414000  
Previous Reading: 10/01/2025 2410500  
Usage: 3500

Service	Current	Past-Due	Balance
MONTHLY MINIMUM	34.00	0.00	34.00
WATER COST	23.70	0.00	23.70
Totals:	57.70	0.00	57.70
DUE DATE	12/10/2025		

**Important Messages**

REMINDER: YOU MAY NOW PAY YOUR BILL VIA DEBIT OR CREDIT CARD. YOU CAN CALL 844-793-7222 OR VISIT [HTTPS://SOUTHCENTRAL.BILLINGDOC.NET](https://southcentral.billingdoc.net) IN ORDER TO DO SO YOU WILL NEED YOUR WEB ID FROM YOUR BILL

IF YOU PAY BY CREDIT OR DEBIT CARD THE VENDOR THAT PROCESSES THE PAYMENTS DOES CHARGE A SERVICE FEE

IF YOU WOULD LIKE YOUR BILL E-MAILED TO YOU SEND REQUEST TO [JSCHMIDT@SOUTHCENTRALWATERND.COM](mailto:JSCHMIDT@SOUTHCENTRALWATERND.COM)

IF YOU ARE INTERESTED IN AUTO PAY PLEASE CALL US AT 258-8710

USAGE ON THIS BILL IS FROM OCTOBER

OUR OFFICE WILL BE CLOSED ON DECEMBER 25TH  
HAVE A SAFE AND HAPPY HOLIDAY!

THANK YOU FOR YOUR PREVIOUS PAYMENT

**USAGE HISTORY IN GALLONS**

NOV 2024	DEC 2024	JAN 2025	FEB 2025	MAR 2025	APR 2025	MAY 2025	JUN 2025	JUL 2025	AUG 2025	SEP 2025	OCT 2025	NOV 2025
15500	2900	3100	3000	3200	3600	2600	8000	16000	38200	24900	13500	3500
H-HELD	H-HELD	H-HELD	H-HELD	H-HELD	H-HELD	H-HELD	H-HELD	H-HELD	H-HELD	H-HELD	H-HELD	H-HELD

PLEASE KEEP THIS PORTION FOR YOUR RECORDS  
SOUTH CENTRAL REGIONAL WATER DISTRICT  
(701) 258-8710





# South Central Regional Water District

(701) 258-8710 • Fax (701) 223-6041  
Office Hours M-Th 8-4:30 and F 8-3  
www.southcentralwaternd.com

P.O. Box 4182  
Bismarck, ND 58502-4182

☐ Check here if you have had a mailing address change  
and indicate this change on the back of the stub.



BISMARCK PARK DISTRICT  
400 E FRONT AVE  
BISMARCK ND 58504-5641

Account Number: 05791540-00  
Service Address: MCDOWELL DAM PARK  
Billing Date: 11/21/2025  
Current Charges: 50.59  
Past Due Charges: 0.00  
Amount Due by 12/10/2025: 50.59  
Amount Due After 12/10/2025: 54.59



883 Web ID

Amount Enclosed: \_\_\_\_\_

PLEASE DETACH AND RETURN THIS PORTION WITH YOUR PAYMENT

Please Make Checks Payable to: SOUTH CENTRAL REGIONAL WATER or SCWD

Account Number: 05791540-00  
Service Address: MCDOWELL DAM PARK  
Last Payment: 127.25 - 10/30/2025  
Billing Date: 11/21/2025

BISMARCK PARK - MCDOWELL DAM  
400 E FRONT AVE  
BISMARCK ND 585045641

Current Reading: 11/01/2025 697200  
Previous Reading: 10/01/2025 694600  
Usage: 2600

Service	Current	Past-Due	Balance
MONTHLY MINIMUM	34.00	0.00	34.00
WATER COST	16.59	0.00	16.59
Totals:	50.59	0.00	50.59
DUE DATE	12/10/2025		

## Important Messages

REMINDER: YOU MAY NOW PAY YOUR BILL VIA DEBIT OR CREDIT CARD. YOU CAN CALL 844-793-7222 OR VISIT [HTTPS://SOUTHCENTRAL.BILLINGDOC.NET](https://southcentral.billingdoc.net) IN ORDER TO DO SO YOU WILL NEED YOUR WEB ID FROM YOUR BILL

IF YOU PAY BY CREDIT OR DEBIT CARD THE VENDOR THAT PROCESSES THE PAYMENTS DOES CHARGE A SERVICE FEE

IF YOU WOULD LIKE YOUR BILL E-MAILED TO YOU SEND REQUEST TO [JSCHMIDT@SOUTHCENTRALWATERND.COM](mailto:JSCHMIDT@SOUTHCENTRALWATERND.COM)

IF YOU ARE INTERESTED IN AUTO PAY PLEASE CALL US AT 258-8710

USAGE ON THIS BILL IS FROM OCTOBER

OUR OFFICE WILL BE CLOSED ON DECEMBER 25TH  
HAVE A SAFE AND HAPPY HOLIDAY!

THANK YOU FOR YOUR PREVIOUS PAYMENT

## USAGE HISTORY IN GALLONS

NOV 2024	DEC 2024	JAN 2025	FEB 2025	MAR 2025	APR 2025	MAY 2025	JUN 2025	JUL 2025	AUG 2025	SEP 2025	OCT 2025	NOV 2025
3900	300	500	200	100	200	1000	9700	9300	14300	21200	12600	2600
H-HELD	H-HELD	H-HELD	H-HELD	H-HELD	H-HELD	H-HELD	H-HELD	H-HELD	H-HELD	H-HELD	H-HELD	H-HELD

PLEASE KEEP THIS PORTION FOR YOUR RECORDS  
SOUTH CENTRAL REGIONAL WATER DISTRICT  
(701) 258-8710





PAYROC COMMERCE, 7840 GRAPHICS DR 200, TINLEY PARK, IL 60477

YOUR CARD PROCESSING STATEMENT

KATHY FEIST  
BISMARCK P&R MCDOWELL DAM  
400 E FRONT AVE  
BISMARCK ND 58504-5641

222298  
P302

Page 1 of 2	THIS IS NOT A BILL
StatementPeriod	10/01/25 - 10/31/25
MerchantNumber	5166188001078800
Customer Service	1-855-786-5871



SUMMARY

An overview of account activity for the statement period.

Page 2	Amounts Submitted	0.00
Page 2	Third Party Transactions	0.00
Page 2	Adjustments/Chargebacks	0.00
Page 2	Fees Charged	-\$7.50
Total Amount Funded to Your Bank		-\$7.50

(Amount Submitted - Third Party) + Adjustments + Chargebacks + Fees Charged = Amount Funded

IMPORTANT INFORMATION ABOUT YOUR ACCOUNT

!ATTENTION!

EFFECTIVE WITH YOUR DECEMBER 2025 STATEMENT, YOU WILL BE BILLED OF UP TO\$99.00 ANNUAL FEE. THIS FEE WILL BE BILLED ANNUALLY AND WILL APPEAR ON YOURSTATEMENT AS A SEPARATE LINE ITEM IN THE MISCELLANEOUS FEES SECTION IDENTIFIED AS ANNUAL FEE. EFFECTIVE DECEMBER 2025, A MONTHLY DEBIT NETWORK SERVICE FEEOF \$10.00 WILL BE ADDED TO THIS ACCOUNT THIS FEE WILL APPEAR ON THE PROCESSING STATEMENTAS A SEPARATE LINE ITEM IN THE SUMMARY OF MISCELLANEOUS FEES, IDENTIFIED AS THEDEBIT NETWORK SERVICE FEE. EVERY MERCHANT WHO ACCEPTS CREDITCARDS MUST FOLLOW THE REQUIREMENTS OF THE PAYMENT CARD INDUSTRY DATA SECURITYTO HELP ENSURE THE SAFETY OF THE PAYMENTS ENVIRONMENT. EFFECTIVE ON YOURDECEMBER 2025 STATEMENT A MONTHLY PCI NON-COMPLIANCE FEE OF UP TO \$74.95APPLIES TO ANY MERCHANT WHO HAS NOT COMPLETED OR UPDATED THEIR PCIATTESTATION. PLEASE COMPLETE YOUR ATTESTATION TO AVOID THIS FEE IN ITS ENTIRETY. GO TO [HTTPS://WWW.PCIAPPLY.COM/PAYROC](https://www.pcipply.com/payroc) TO LOG IN AND GET STARTED.CONTINUING YOUR MERCHANT ACCOUNT WITH US OR USE OF YOUR MERCHANT ACCOUNT AFTER 30 DAYS WILL REPRESENT YOUR ACCEPTANCE TO THESE TERMS.

AMOUNTS FUNDED BY BATCH

(Amount Submitted - Third Party) + Adjustments + Chargebacks + Fees Charged = Amount Funded

Date Submitted	Batch Number	Submitted Amount	Third Party Transactions	Adjustments/ Chargebacks	Fees Charged	Funded Amount
	Month End Charge	0.00	0.00	0.00	-\$7.50	-\$7.50
Total		0.00	0.00	0.00	-\$7.50	-\$7.50



Bliss Law Firm, LLC  
7918 223rd St. NE  
McKenzie, ND 58572

Burleigh County Water Resource District  
PO Box 1255  
Bismarck, ND 58502-1255

December 2, 2025

Invoice #664

Professional Services

		<u>Hrs/Rate</u>	<u>Amount</u>
11/10/2025	(904) Receipt and review of email from Manager Mischel regarding McDowell Dam leases; research chronology of Missouri Valley Aero Club leases from 2002 forward; follow-up telephone call to Zac Heskin of the Aero Club regarding the Club's intentions to renew lease; follow-up email to Heskin, copy to Manager Mischel regarding same.	1.00 316.00/hr	316.00
	(904) Review lease agreements and amendments on Braun farmland lease; follow-up telephone call to Alvin Braun, left message.	0.80 316.00/hr	252.80
	(904) Review Missouri Civil Air Patrol lease drafts, executed lease agreement; review relationship to Aero Club for sharing space.	0.80 316.00/hr	252.80
	(312) Telephone call from Mike Gunsch regarding County Commission/Garrison Conservancy District.	0.50 316.00/hr	158.00
	(904) Draft new combined Aero Club/CAP lease agreement.	1.00 316.00/hr	316.00
	(312) Draft new Braun lease agreement.	1.00 316.00/hr	316.00
11/11/2025	(312) Receipt and review of Commissioner Woodcox's resolution documents from Wendy; review resolution; review NDCC regarding a county's ability to withdraw from the Conservancy District, review caselaw regarding same.	2.00 316.00/hr	632.00
	(312) Follow-up telephone call to Chairman Landenberger regarding Commission resolution.	0.70 316.00/hr	221.20
	(312) Follow-up telephone call to Manager Reep regarding Commission resolution.	0.60 316.00/hr	189.60

	<u>Hrs/Rate</u>	<u>Amount</u>
11/11/2025 (312) Telephone call from Mike Gunsch regarding Commission resolution; receipt and review of position papers regarding same.	0.80 316.00/hr	252.80
(312) Receipt and review of Board request for me to send information to State Auditor; review file; draft letter to Board regarding same.	0.50 316.00/hr	158.00
11/12/2025 (312) Prepare for board meeting; attend board meeting.		1,000.00
Telephone call from Manager Jones regarding County Commission and Garrison Conservancy District matter, return call.	0.40 316.00/hr	126.40
(904) Review Braun lease agreements with the District for McDowell Dam farm property; follow-up telephone call to Dave at McDowell Dam, obtain additional contact information for Alvin Braun; draft letter to Braun on District letterhead for Manager Mischel's review and signature; email correspondence to/from Chuck regarding same; receipt of signed letter from Chuck, send letter.	0.80 316.00/hr	252.80
(904) Review ND Wing Civil Air Patrol lease agreement with the District; follow-up email to CAP legal regarding whether the CAP wishes to renew lease agreement.	0.80 316.00/hr	252.80
11/14/2025 Receipt and review of CAP response to my email regarding CAP's lease agreement with McDowell Dam; follow-up email to Wendy, Chuck regarding Braun farm lease, execution of Braun letter from Board.	0.50 316.00/hr	158.00
For professional services rendered	12.20	\$4,855.20
Previous balance		\$2,390.40
Accounts receivable transactions		
11/25/2025 Payment - Thank You.		(\$2,390.40)
Total payments and adjustments		(\$2,390.40)
Balance due		<u>\$4,855.20</u>

Please note our new street address for future payments and correspondence:  
 7918 223rd St. NE  
 McKenzie, ND 58572



Fronteer Professional Services Inc  
1838 E Interstate Ave Ste B  
Bismarck, ND 58503

Date: November 30, 2025  
Invoice #: 0000005282  
Terms: Net

Burleigh Co. Water Resource District  
PO BOX 1255  
BISMARCK, ND 58502-  
(701)426-6439

**Total Due: \$2,340.00**

---

Fronteer Professional Services Inc 1838 E Interstate Ave Ste B, Bismarck, ND 58503

---

Description	Amount	Total
Monthly Administrative Work - per agreement	\$2,250.00	\$2,250.00
Terminal Server Fees	\$90.00	\$90.00
<b>Total:</b>		<b>\$2,340.00</b>

Thank you for your business!





Fronteer Professional Services Inc  
1838 E Interstate Ave Ste B  
Bismarck, ND 58503

Date: October 31, 2025  
Invoice #: 0000005235  
Terms: Net

Burleigh Co. Water Resource District  
PO BOX 1255  
BISMARCK, ND 58502-  
(701)426-6439

**Total Due: \$64.55**

---

Fronteer Professional Services Inc 1838 E Interstate Ave Ste B, Bismarck, ND 58503

---

Description	Amount	Total
October 2025 Presort Charges	\$64.55	\$64.55
<b>Total:</b>		<b>\$64.55</b>

Thank you for your business!

(701) 226-0227

# INVOICE

Invoice #	Date
10007	11/28/2025

BILL TO

# Burleigh County Water Resource District

PO Box 1255

Bismarck, ND 58502-1255

Customer ID	Terms
	Due Upon Receipt

Description	QTY	Unit Price	Amount
Burnt Creek Levee Inspection November 15, 2025 (hr)	1	\$120	\$120
Burnt Creek Levee Inspection Report Generation (hr)	1	\$120	\$120
		<b>Total</b>	<b>\$240</b>







INVOICE

Please Remit To:  
Office of the State Auditor  
600 East Boulevard - Dept. 117  
Bismarck ND 58505-0400  
United States

Page: 1  
Invoice No: SA0000020247  
Invoice Date: 11/17/2025  
Customer Number: 8000  
Payment Terms: Due Immed  
Due Date: 11/17/2025

Bill To:  
  
BURLEIGH COUNTY  
County Auditor  
PO BOX 5518  
BISMARCK ND 58506

AMOUNT DUE: 27,040.00 USD



Amount Remitted

For billing questions, please call 701-328-2241

Line	Adj	Identifier	Description	Quantity	UOM	Unit Amt	Net Amount
1		AUDIT FY 24	Audit - Fiscal Year 2024	1.00	EA	12,488.17	12,488.17
		FINAL BILL - COUNTY PORTION					
2		NAS	Non-Audit Services	1.00	EA	1,417.87	1,417.87
		FINAL BILL - COUNTY PORTION					
3		SA	Federal Single Audit	1.00	EA	5,044.35	5,044.35
		FINAL BILL - COUNTY PORTION					
		PROJECT HOURS AND COSTS - COUNTY PORTION:					
		AUDIT - 258.25 - \$27,918.11					
		NON-AUDIT SERVICES - 77.25 - \$8,314.38					
		SINGLE AUDIT - 86.25 - \$9,337.90					
4		AUDIT FY 24	Audit - Fiscal Year 2024	1.00	EA	5,716.66	5,716.66
		FINAL BILL - WRD PORTION					
5		NAS	Non-Audit Services	1.00	EA	2,372.95	2,372.95
		FINAL BILL - WRD PORTION					
		PROJECT HOURS AND COSTS - WRD PORTION:					
		AUDIT - 53.00 - \$5,716.66					
		NON-AUDIT SERVICES - 22.00 - \$2,372.95					
SUBTOTAL:							27,040.00
TOTAL AMOUNT DUE :							27,040.00

PeopleSoft BI  
INVOICE PRINT SUMMARY - SELECTED BILLS

Report ID: BIIVCPN  
Report Action: INVOICE

Page No. 1  
Run Date 11/17/2025  
Run Time 22:10:26

<u>Business Unit</u>	<u>Number of Bills</u>	<u>Total Invoice Amount</u>	<u>Currency</u>
11700	1	27,040.00	USD

---

Total number of bills printed: 1



## REMIT TO:

P.O. BOX 2383  
BISMARCK, ND 58502  
701-222-1212  
FAX: 701-222-2420  
TOLL FREE: 1-800-726-4767







## INVOICE

NUMBER	0167579
DATE	11/24/2025
CUSTOMER	105010
P.O. #	Wendy
ORDERED BY	Wendy Egli @ Frontee

[www.proformsusa.com](http://www.proformsusa.com)

SOLD TO	SHIPPED TO
Burleigh County Water Resource PO Box 1255 Bismarck, ND 58502-1255	Fronteer Professional Service 1838 E Interstate Ave Ste B Bismarck, ND 58503

PLEASE PAY FROM THIS INVOICE. WE SINCERELY APPRECIATE YOUR BUSINESS.

OUR ORD. #	DATE SHIPPED	SHIPPED / VIA	SALESPERSON	TERMS		
130966	11/24/2025	Best Way	Office C1	Net 10 Days		
QTY ORDERED	QTY SHIPPED	DESCRIPTION / ITEM CODE		UNIT PRICE	U/M	EXTENSION
250	250	Burleigh County Water Resources checks CX		624.00	M	156.00
<div>Online Credit Card Payment</div> <div><a href="https://www.proformsusa.com">https://www.proformsusa.com</a></div> <div><div></div><div></div><div></div><div></div></div> <div>PLEASE PAY FROM THIS INVOICE - No statement will be sent.</div> <div>PLEASE PAY THIS AMOUNT</div>						

## COMMENTS:

A finance charge of 1-1/2% per month (18% annually) will be added to this invoice if not paid within terms specified above.

\* All custom orders subject to 10% overrun or underrun for most economical use of materials.

Unless otherwise specified, the price quoted is for a single shipment F.O.B. point of manufacture or distribution.

Net Sale:

156.00

Sales Tax:

.00

Freight:

17.27

Total:

173.27

Thank You!

Accounting Copy

Page 1 of 1